

HDT

sportparts

PERFORMANCE PARTS CATALOGUE





PERFORMANCE PARTS CATALOGUE

Incorporating

- **Engine**
- **Suspension**
- **Transmission**
- **Wheels & Tyres**
- **Body**

Also including Group A competition homologated engine, body and transmission parts.



Engine Group

ENGINE GROUP

Engine 1

10000	CYLINDER HEAD BARE	Standard equipment VH & VK LM5000. N.L.A. Use Part No. 10105.
10001	CYLINDER HEAD ASM	N.L.A. Use Part No. 10106.
10002	CYLINDER HEAD BARE	5.0L XTS standard production unit machined same as 10105. Suitable for use all "Blue & Black" series 5.0L leaded engines.
10003	CYLINDER HEAD ASM	Complete same as 10106.
10004	CYLINDER HEAD BARE	4.2L "SS" VH Group 3 unit with revised valve throats. Standard valve size. N.L.A.
10005	VALVE - INLET	1.9" dia head with waisted chrome stem. Standard equipment all 5.0L "SS" VH/VK & A9L Commodore and Police Pursuit vehicles when equipped with HDT Engine Performance Package. Suit all 5.0L leaded cylinder heads.
10006	VALVE EXHAUST	1.6" dia head. Same specification and application as 10005.
10007	SPRING - VALVE	L34 heavy duty unit, single outer coil with reverse spiral inner damper. For use with engine speeds to 6500 rpm. Suitable for use without modification in all 4.2/5.0L engines. Std equipment L34 & A9L GP A engines.
10008	MANIFOLD - INLET	Gasflowed unit as fitted as standard equipment on VC HDT Commodore. N.L.A.
10009	MANIFOLD - INLET	"SS" 5.0L VH/VK Bathurst unit with redesigned port runners and carburettor inlet venturi. Same unit as used on our race cars. Standard equipment Police Pursuit vehicles. This unit should be used in conjunction with either 10105 or 10002 cylinder heads. Suitable also for use on 4.2L "Blue" engines but not earlier 4.2 or 5.0L "red" cylinder heads, (difference in bolt pattern).
10010	RING SET - PISTON	For use with L34 pistons (flat top) standard size (4.0 ₉).
10011	PISTON & PIN	L34 high performance, flat top slipper design, for use in all high performance 5.0L engines. Available in matched and graded sets to HDT specifications. Standard size (4.0 ₉).
10012	PISTON ASM	L34 standard size, complete with pin and rings.
10013	PISTON ASM	L34 .020" oversize complete with pin and rings.
10014	PISTON ASM	L34 .030" oversize complete with pin and rings.
10015	RING SET - PISTON	L34 .020" oversize.
10016	RING SET - PISTON	L34 .030" oversize.
10017	CONROD	L34 heavy duty replacement to meet the demands of high performance applications. Featuring a heavier sectioned profile with 3/8" big end bolts and nuts. For use with engine speeds to 6500 rpm. Standard equipment all HDT VH high output engines; A9L Group A, HDT race Group A engines and VK 4.9 standard production manual or automatic trans engines.
10018	BOLT - CONROD	L34 3/8" heavy duty.
10019	NUT - CONROD BOLT	L34 3/8" Grade 8.
10020	BEARING SET	Conrod, standard size. Designed for all heavy duty competition and street applications. Manufactured in copper lead and suitable for all 4.2 & 5.0L engines. Use exclusively in HDT Group A race engines.
10021	BEARING SET	Conrod .001" undersize, heavy duty.
10022	BEARING SET	Conrod .101" undersize, heavy duty.
10023	BEARING SET	Conrod .020" undersize, heavy duty.
10024	BEARING SET	Main, standard size. A heavy duty bearing set for all competition and street applications. Manufactured in copper lead and suitable for all 4.2 & 5.1L engines. Used exclusively in HDT Group A race engines.
10025	BEARING SET	Main .001" undersize, heavy duty.
10026	BEARING SET	Main .101" undersize, heavy duty.

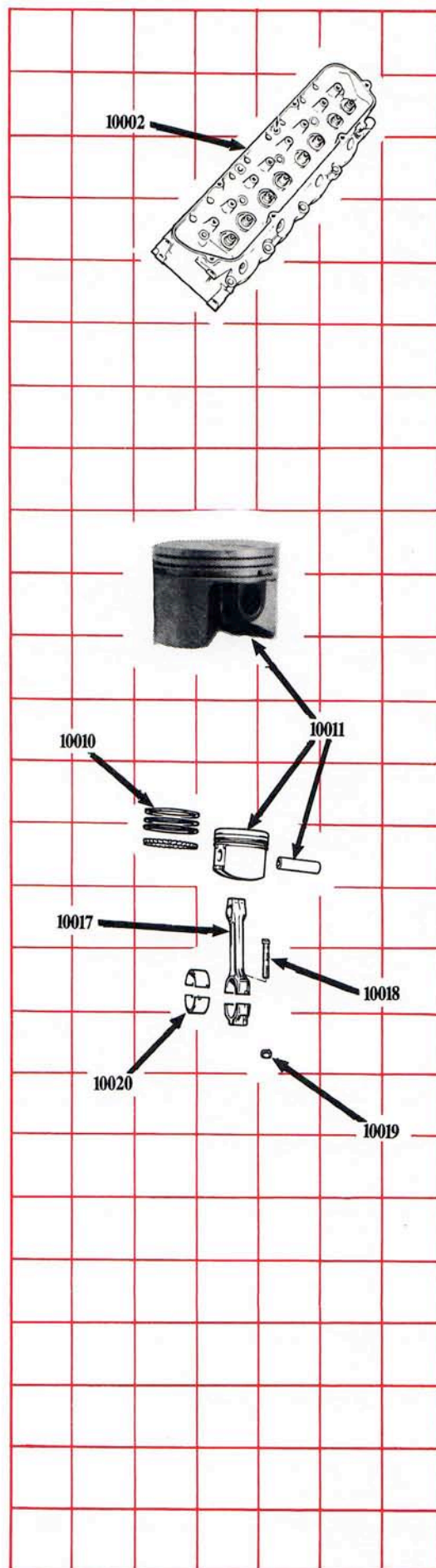

- 10027 BEARING SET** Main .020" undersize, heavy duty.
- 10028 BEARING SET** Camshaft, heavy duty, std. size, suit all V8 Holden engines. Used exclusively HDT Group A race engines.
- 10029 BEARING SET** Camshaft, heavy duty, std. * .002", suit all V8 Holden engines. Same spec. as 10028.
- 10030—10047 N.L.A.**
- 10048 CHAIN TIMING** Double row heavy duty full roller unit for all road and race 4.2 & 5.0L engines. Standard equipment A9L Group A race engines.
- 10049 KIT-FUEL PUMP** L34 high pressure. For use in all 4.2 & 5.0L high performance engines. Standard equipment all A9L Group A engines.
- 10050 HEADERS-EXHAUST** Exhaust extractor set (headers) specially manufactured to HDT specifications and used as standard equipment all Group 3 VH "SS", LM5000, HDT Improved 5.0L and early production VK "SS" base and Group 3 vehicles. Suit all 4.2 & 5.0L Commodores. N.L.A. use 10091 or 10135.
- 10051 CONNECTING PIPE** Exhaust connecting pipe set to be used in conjunction with 10050 header set. Suit VB/VC Commodore 4.2 & 5.0L dual system. N.L.A. use 10139.
- 10052 CONNECTING PIPE** Exhaust connecting pipe set, use with 10050 to suit VH dual to standard system. N.L.A. use 10139.
- 10053 CONNECTING PIPE** Exhaust connecting pipe set, use with 10050. Suit VH "SS" Group 3 5.0L LM5000 to 2 1/2" "SS" system. N.L.A. use 10139.
- 10054 PIPE ASM** "Y" section. Connects header connecting pipe set to intermediate muffler, for use on 2 1/2" system. Standard equipment VH "SS" 5.0L, early production LM5000 and Police Pursuit vehicles when fitted with HDT Engine Performance package. N.L.A. from HDT. Use GMH part no. 92020710.
- 10055 MUFFLER ASM** Intermediate, 2 1/2" system. Standard equipment VH "SS" 5.0L, early LM5000 and Police Pursuit vehicles. N.L.A. from HDT. Use GMH part no. 92020745.
- 10056 MUFFLER ASM** Rear with tailpipe, 2 1/2" system. Standard equipment VH "SS" 5.0L, early LM5000 and Police Pursuit vehicles. N.L.A. from HDT. Use GMH part no. 92020711.
- 10057 N.L.A.**
- 10058 EXHAUST SYSTEM** Jackaroo, all 1.8 litre models. For use only with 10057 header set. A free flow unit designed for maximum efficiency without undue noise. N.L.A.
- 10059 PLATE-PRESSURE** clutch, uprated. This is an 1150 kg clamping load unit, used as standard equipment all "SS" VH/VK, LM5000, Police Pursuit and A9L Group A vehicles. Suit all model 4.2, 4.9 & 5.0 litre engines. Recommended for use with 10061.
- 10060 CLUTCH KIT-H.D.** Comprising 1300 kg clamping load pressure plate, 10061 driven plate and clutch thrust bearing. Suitable for use in all 4.2, 4.9 & 5.0 litre high performance engines. Please note that fitment of this unit will increase clutch pedal effort.
- 10061 PLATE-DRIVEN** Clutch, heavy duty unit. Standard equipment all VH "SS" 5.0L, LM5000, VK base "SS" & Group 3, Police Pursuit vehicles and A9L Group A.
- 10062 FLYWHEEL** Lightweight kg L34 type. Use as standard equipment all VH/VK "SS" 5.0L, LM5000, Police Pursuit vehicles.
- 10063 SUMP ASM** Anti-surge design, baffled. Standard equipment VH/VK "SS", LM5000, Police Pursuit vehicles. Suit all V8 Commodore with standard pick up pipe.
- 10064 CAMSHAFT** Jackaroo when used with 10057 & 10058, will increase horsepower to 72 b.h.p. This is a changeover unit. We have developed this unit to provide not only an increase in engine output, but also to give better engine response without loss of flexibility and reliability. N.L.A.

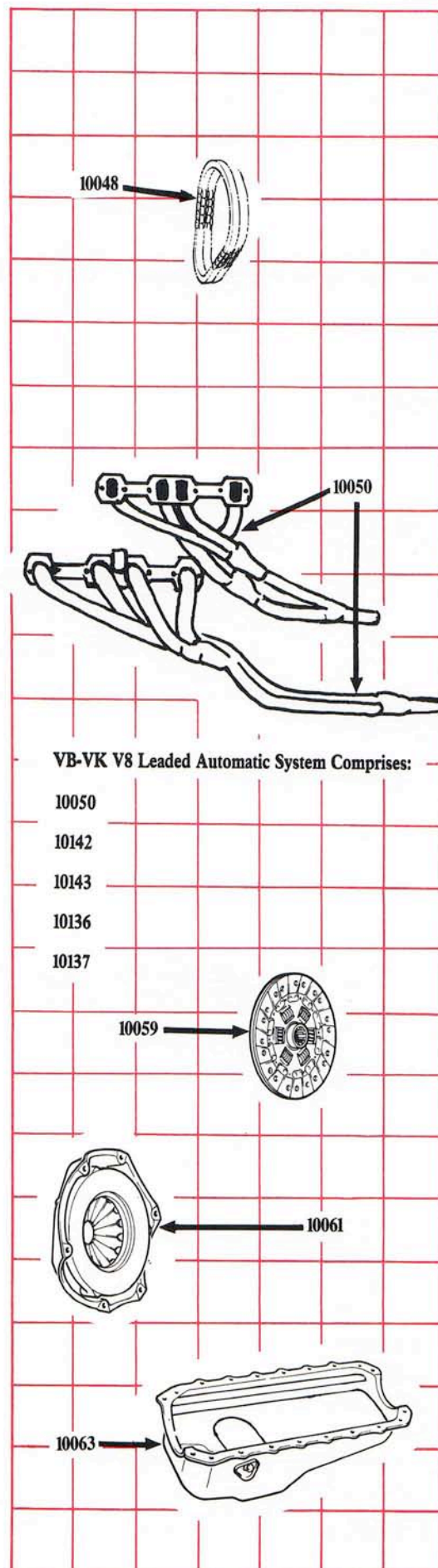

VB-VK V8 Leaded Automatic System Comprises:

10050

10142

10143

10136

10137

- | | | |
|--------|-----------------------------|------------------------------------------------------------------------------------------------------------------------------------------------------------------------------------------------------------------------------------------------------------------------------------------------------------------------|
| 10065 | ROCKER COVER | Chrome left hand. Standard equipment all HDT built Commodores. |
| 10066 | ROCKER COVER | Chrome RH. Same applications as 10065. |
| 10067 | CAP - OIL FILLER | Chrome. For use with 10065 |
| 10068 | BOLT & PLATE SET | Chrome. For use with 10065 & 10066. |
| 10069 | PLATE - DRIVE | Clutch, heavy duty unit, 10" x 26 spline. For use with HDT T5 speed transmission when fitted to any model 4.2 or 5.0L engine. Suit BW T10 also. Std. equipment VL Group A. |
| 10070 | ROCKER COVER DUCT | Chrome. For Jackaroo petrol engine. This is a changeover unit. N.L.A. as of Feb '85. |
| 10071 | DUCT | Cold air. Standard equipment all VH/VK "SS", LM5000, all HDT Improved vehicles and Police Pursuit vehicles. |
| 10072 | SLEEVE | Cold air duct connection to air cleaner intake. Standard equipment VH/VK "SS", LM5000, HDT Improved vehicles and Police Pursuit vehicles. Also Statesman Magnum. |
| 10073 | AIR CLEANER ASM | Complete cold air unit. Std. equipment VH/VK "SS", LM5000, HDT Improved vehicles and Police Pursuit vehicles. |
| 10073A | AIR CLEANER COVER | Same as 10073 but excludes duct & sleeve. |
| 10074 | COVER | Air Cleaner top, chrome. Std. equipment all HDT VH/VK vehicles; 4.2 & 5.0L. |
| 10075 | DECAL | Air Cleaner chrome cover. "Peter Brock 5.0L". Same application as 10074. |
| 10076 | DUCT | Cold air, standard equipment HDT Statesman Magnum (WB). Will suit earlier models. N.L.A. |
| 10077 | AIR CLEANER ASM | Complete cold air unit. Std. equipment WB Statesman Magnum. Will suit earlier models. N.L.A. |
| 10077A | AIR CLEANER ONLY | Statesman Magnum (WB). N.L.A. |
| 10078 | TIE - CABLE | Cold air duct sleeve. Secures sleeve to cold air duct and air cleaner intake. Std. equipment late VH "SS" Group 3 November '83 on, also HDT improved vehicles, LM5000, Statesman Magnum, VK "SS" & Group 3. |
| 10079 | BASE - AIR | Ram air unit, when fitted as option to VH CLEANER "SS" Group 3 vehicles and other HDT models since that model. Unit is complete with bonnet to air cleaner seal and should be used with VH "SS" Group 3 bonnet scoop, refer Body Group Section, Part No. 40022. |
| 10080 | SEAL - RAM AIR | To suit 10079 unit when purchased as a separate item. |
| 10081 | LIFTER SET | A high speed unit intended for use with HYDRAULIC modified hydraulic camshafts in 4.2 & 5.0L engines. For use to 6500 r.p.m. Standard equipment all HDT High Output engines. This lifter is manufactured to the exact overall dimensions of the std. GMH part and can be fitted without change to pushrod length, etc. |
| 10082 | DISTRIBUTOR ASM | Modified electronic unit, for use in 5.0L manual transmission vehicles. Standard equipment VH "SS" & Group 3, HDT Improved vehicles, LM5000, Statesman Magnum, VK "SS" & Group 3, Police Pursuit engines. |
| 10083 | DISTRIBUTOR ASM | Same unit as 10082, but for use in 5.0L automatic transmission vehicles. |
| 10084 | ROCKER COVER | Chrome left hand. WB Statesman Magnum. |
| 10085 | ROCKER COVER | Chrome right hand. WB Statesman Magnum. For all other related parts, use 10067 & 10068. |
| 10086 | HEADER SET | An HDT development for specific use on Statesman Magnum engines. Can be used on earlier model Statesman vehicles. |
| 10087A | CONNECTING PIPE | For use with 10086 (Statesman Magnum) when fitted with Trimatic transmission. Connects header set to standard WB system. |
| 10087B | CONNECTING PIPE | For use with 10086 (Statesman Magnum) when fitted with Turbo 350 transmission. connects header set to standard WB system. |
| 10088 | KIT - CLUTCH | Heavy duty pressure and driven plate set. For use on all "Red" series 138/202 6 cylinder engines. Recommended for use on modified engines and XU-1. N.L.A. |

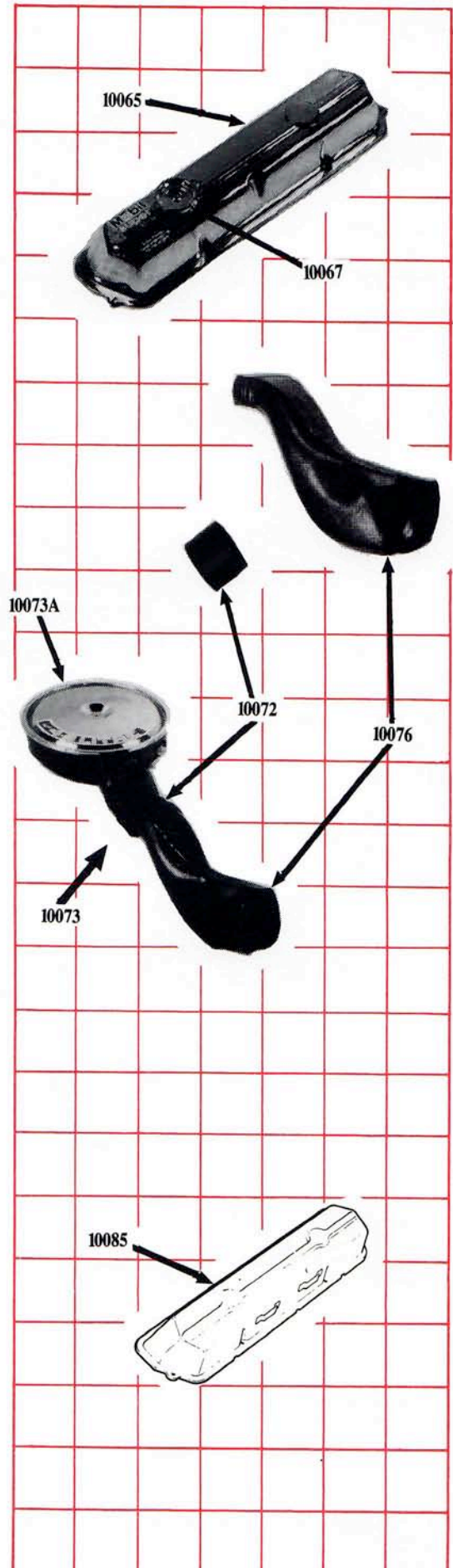

10089	TRAY - WINDAGE	L34 type. For use in all high speed 4.2 & 5.0L engines. N.L.A.
10090	STUD 6 LOCK NUT	L34 windage tray stud complete with washer & lock nut. For use only with 10089. N.L.A.
10091	HEADER SET	Group A. Complete with left & right hand primary header pipes; left & right hand secondary extension pipes. Std. equipment VK "SS". Secondary extension pipes connect up to standard road exhaust system on VK "SS". Suitable for use on other model VK 5.0L Commodore Man. Trans.
10092	HEADER	Left hand, road & race, Group A. Standard equipment VK "SS" & Group 3. Will fit earlier 5.0L Commodore. Use with cylinder head 10105. Homologated for Group A VK race engines.
10093	HEADER	Right hand. Same application as 10092.
10094	PIPE - EXTENSION	Left hand. Connects Group A header set to standard production exhaust system. Std. equipment VK "SS". Will suit other model VK.
10095	PIPE - EXTENSION	Right hand. Same application as 10094.
10096	PIPE - EXTENSION	Left hand. Same application as 10095, but for VK "SS" Group 3 only. Deleted late Feb '85.
10097	PIPE - EXTENSION	Right hand. Same application as 10096. Deleted late Feb '85.
10098A	CLAMP ASM	Comprises 10098A/99/100/101.
10098	"U" BOLT	Exhaust clamp Group A. Header to extension pipe. No. per set ⁹ VK "SS" - 4; VK "SS" Gp 3 - 6.
10099	SADDLE	Exhaust "U" bolt, Group A. Used in conjunction with 10098.
10100	WASHER	Exhaust "U" bolt Group A. Used with 10098.
10101	NUT	Exhaust "U" bolt Group A. Used with 10098.
10102	MUFFLER ASM	Intermediate, revised. To be used in conjunction with 10096 & 10097. Std. equipment VK "SS" Group 3 only. Deleted late Feb '85. For replacement, use 10136 with 10137 or 10151.
10103	MUFFLER ASM	Rear, revised. Complete with tailpipe, to be used only with 10102. Std. equipment VK "SS" Group 3 only. For replacement, use 10136 with 10151.
10104	EXHAUST SYSTEM	Complete VK "SS" Group 3. Comprising header and extension pipe set with intermediate & rear muffler assemblies. N.L.A. use replacement part 10091 with 10150.
10105	CYLINDER HEAD	5.0L XT5 "B" series casting. (same as BARE 10000), but second design for '84/'85 with revised combustion chamber shape, raised chamber floor, revised valve seat and throat radius, retaining 1.9" inlet & 1.6" exhaust valves. Exhaust ports have been raised to allow the use of 10092 & 10093 exhaust header for Group A racing. Identified externally with "HDT" stamp. Standard equipment all VK "SS" & Group 3, and HDT Improved vehicles late October '84 on. Lead engines only.
10106	CYLINDER HEAD	Complete with all components, including ASSEMBLED chrome stem valves. Same unit as 10105.
10107	EXHAUST EXTENSION	Black Chrome, tailpipe. Std. equipment VK "SS".
10108	CAMSHAFT A9L	Crane billet unit jointly developed with HDT for Group A racing. Std. equipment VK "SS" Group A Commodore.
10109	LIFTER A9L	For use with 10108.
10110	PUSHROD A9L	A case hardened unit 3mm longer than std. GM part. Must only be used with 10114.
10111	ROLLER ROCKER	Crane set, std. equipment all A9L VK ARM engines. Set is complete with locknuts.
10112	LOCKNUT A9L	For use with 10111.
10113	ROCKER ARM STUD	A9L, VK & VL Group A, for use with 10111, 10115, 10116, 10117, 10285 & 10302.
10113A	ROCKER STUD SET	A9L, VK & VL Group A, full engine set.
10114	GUIDE PLATE A9L	Standard equipment all VK A9L engines. For use only with 10110, 10115, 10116 & 10117.

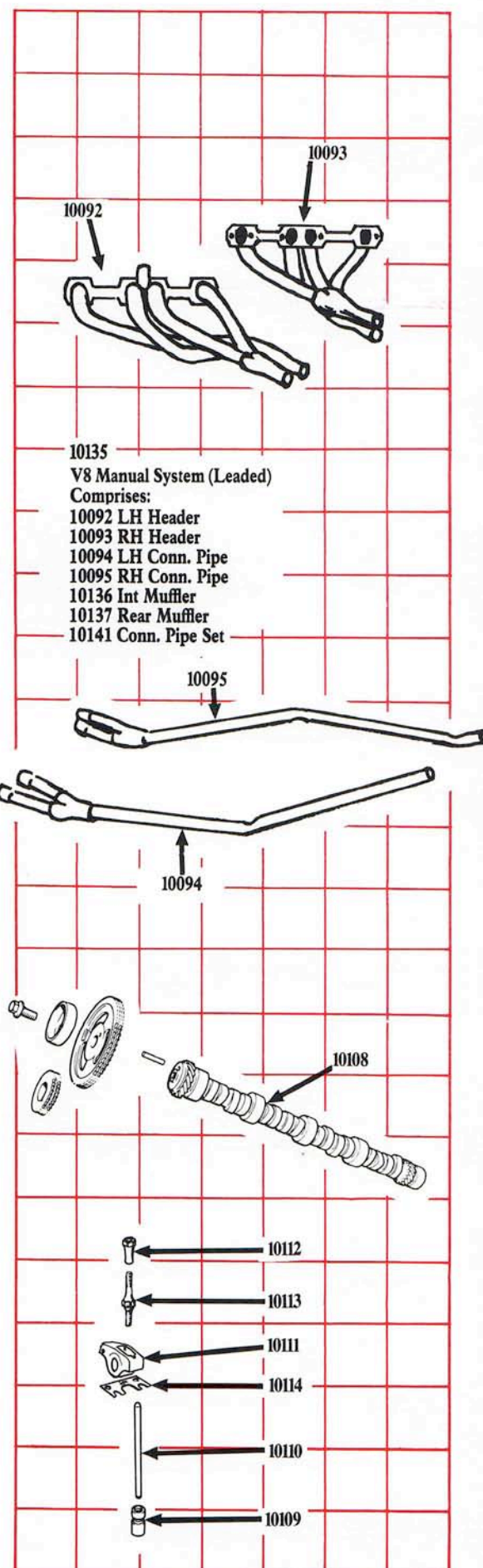

10114A	GUIDE PLATE SET	A9L, VK full engine set.
10115	CYLINDER HEAD	A9L bare. VK Group A.
10116	CYLINDER HEAD	A9L assembled with 10005, 10006 valves, 10007 valve springs, 10114 guide plates and 10113 studs. VK Group A.
10117	CYLINDER HEAD	A9L assembled same as 10116 includes 10111 rocker arms.
10118	INLET MANIFOLD	A9L. VK Group A.
10119	ROCKER COVER LH	A9L chrome. VK & VL Group A. Modified for rocker arm clearance.
10120	ROCKER COVER RH	A9L chrome. VK & VL Group A. Modified for rocker arm clearance.
10121	DAMPER ASM	A9L, VK, nodular iron, complete with retaining plates & associated hardware.
10122	DAMPER ONLY	A9L. VK & VL Group A.
10123	RETAINER PLATE	A9L damper, 4 per unit. VK Group A.
10124	BOLT, DAMPER	A9L retainer plate. VK Group A.
10125	SPACER, DAMPER	A9L retainer plate. VK Group A.
10126	FLYWHEEL ASM	A9L lightweight. VK & VL Group A.
10127	CAMSHAFT	4.9 Litre, standard production.
10128	ENGINE ASM	4.9 short.
10129	ENGINE ASM	4.9 Long, Group 3.
10130	ENGINE ASM	4.9 complete, Group 3.
10131	ENGINE ASM	5.0 long, Group 3 (N.L.A.)
10132	ENGINE ASM	5.0 complete, Group 3 (N.L.A.)
10133	N.L.A.	
10134	DECAL	4.9 litre air cleaner
10135	EXHAUST SYST	Big Bore Sports comprised Group A Header set, connecting pipes, intermediate & rear mufflers and clamps. Suit all model 4.2 & 5.0 VB to VK manual Commodore Sedans.
10136	MUFFLER	Big Bore, intermediate, part of 10135.
10137	MUFFLER	Big Bore, rear, part of 10135.
10138	CLAMP ASM	Big Bore 2 5/8", part of 10135.
10139	EXHAUST SYST	Big Bore sports comprises connecting pipe adaptors, intermediate and rear mufflers & clamps. For use on VK "SS" & VK GP A "SS".
10140	CONNECTING	Big Bore, adapts VK "SS" & Group A PIPE SET connecting pipes to intermediate muffler. Part of 10139.
10141	CONNECTING	Connects 10050 header set to Big Bore PIPE SET Exhaust system.
10142	CONNECTING	Part of 10141. PIPE, LH
10143	CONNECTING	Part of 10141. PIPE, RH
10144	KIT, FUEL PUMP	Mechanical, for use all 5.0 & 4.9 VK manual Commodores.
10145	KIT, FUEL PUMP	Mechanical, suitable for VK 5.0 & 4.9 Calais.
10146	CAMSHAFT	High output, hydraulic, for use all 4.9 & 5.0 manual engines. Use with 10081.
10147	SPROCKET	For use with 10146 and 10148 high output camshafts.
10148	CAMSHAFT	High output, hydraulic, for use all 4.9 & 5.0 automatic engines. Use with 10081.
10149	ENGINE ASM	4.9 Group 3 Marine. This is a high performance asm purpose built for ski boats. Each engine features L34 conrods, 10148 camshaft and 10081 lifter set, L34 valve springs, L34 flywheel, A9L damper, blue printed carburettor and electronic distributor, Bathurst inlet manifold, big valve heads, double row chain, L34 fuel pump. Std equipment incl. starter motor and oil pump, no water pump or alternator.

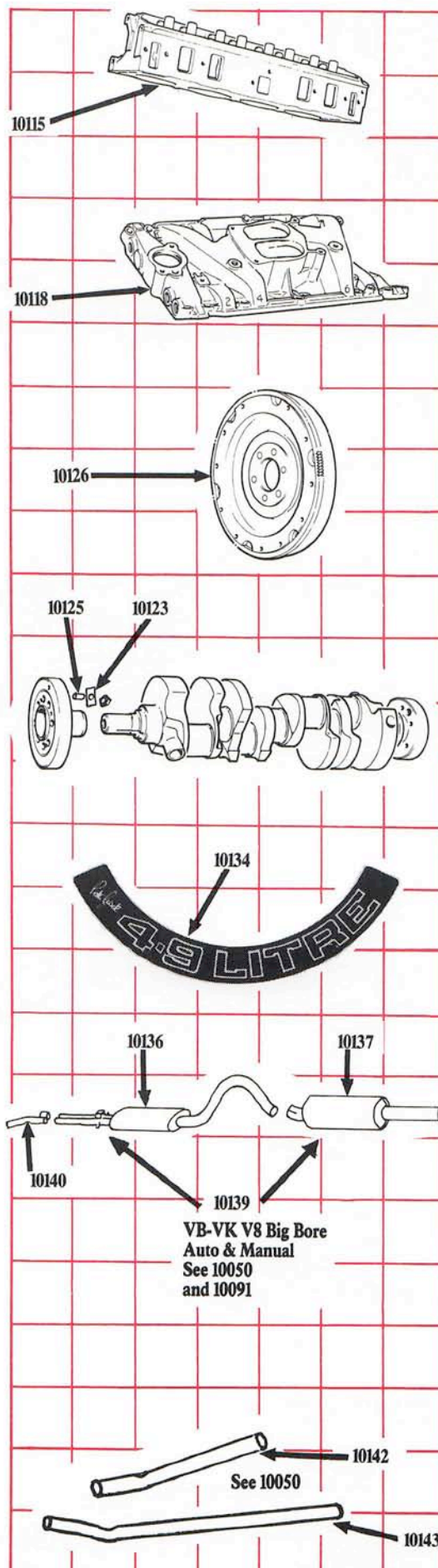

10150	EXHAUST SYST	VK Group 3 Big Bore complete. Same as 10135 with 10151 rear muffler with upswept tailpipe which protrudes through rear skirt. This system can also be used on all manual VB to VK V8 Commodore sedans.
10151	MUFFLER, REAR	VK Group 3 Big Bore.
10152	MUFFLER, REAR	Big Bore Commodore Wagon, all models.
10153	EXHAUST SYST	Big Bore complete, header to tailpipe with the exception of change in rear muffler to 10152. Suit all VB-VK V8 automatic wagons.
10154	EXHAUST SYST	Big Bore complete, same as 10135 but with 10152 rear muffler. Suit all VB-VK manual wagons.
10155	INLET MANIFOLD	VK "SS" & Group 3 hand finished to full A9L Group A race specs. Port runners are hand ground to match cylinder head inlet ports. Suit all V8 blue engines 1980 - on, road and race.
10156	N.L.A.	
10157	CYLINDER HEAD	Bare, Group 3 hand finished. All ports are fully hand ground and recountered for high output applications. Compression ratio is 9.4:1 when installed on VC to VK 308 engines with std pistons & 9.0:1 for VK 4.9 engines. Suit all V8 4.9 & 5.0 engines VC to VK.
10157A	N.L.A.	
10158	CYLINDER HEAD	Bare A9L handfinished. Same specification & application as 10157 but for use with roller rocker arms as per VK Group A.
10159	N.A.	
10160	N.A.	
10161	N.A.	
10162	N.A.	
10163	N.A.	
10164	N.A.	
10165	N.A.	
10166	N.A.	
10167	N.A.	
10168	PISTON SET	Cosworth, VK & VL Group A race. Forged piston set complete with taper bore pins & circlips. To suit 4.003" bore blocks.
10169	N.A.	
10170	HEAD GASKET	Standard production 4.9 & 5.0 engines.
10171	N.A.	
10172	N.A.	
10173	GASKET	Rocker cover, std. production 4.2, 4.9 & 5.0 engines.
10174	N.A.	
10175	N.A.	
10176	N.A.	
10177	N.A.	
10178	N.A.	
10179	N.A.	
10180	GASKET, SUMP	All Holden V8 engines.
10181	GASKET	Oil pump pick up pipe to cyl. block, suit all Holden V8 engines.
10182	N.A.	
10183	GASKET, WATER	Suit all Holden V8 engines. PUMP
10184	GASKET, TIMING	Suit all Holden V8 engines. COVER
10185	OIL SEAL	Timing cover, suit all Holden V8 engines.
10186	OIL SEAL	Crankshaft rear, rope. Suit all Holden V8 engines.
10187	GASKET, FUEL	Suit all Holden V8 engines. PUMP
10188	GASKET	Oil pump to cylinder block. All Holden V8 engines.
10189	GASKET	Oil pump housing intermediate. All Holden V8 engines.
10190	N.A.	

10191	BOLT, OIL PUMP	To cylinder block. All Holden V8 engines.
10192	SWITCH, OIL	PRESSURE
10193	GEAR	Oil pump shaft drive. Suit all Holden V8 engines.
10194	PIN	Oil pump shaft drive gear. Suit all Holden V8 engines.
10195	SHAFT	Oil pump drive. All Holden V8 engines.
10196	BOLT	Oil pump pick up pipe to cylinder block.
10197	PLUG	Cylinder block oil gallery front.
10198	PLUG	Cylinder block oil gallery rear.
10199	PLUG	Sump drain.
10200	BOLT	Sump.
10201	BOLT	Sump x 2.
10202	LOCATOR	Camshaft, thrust.
10203	BOLT	Camshaft locator.
10204	BOLT	Camshaft sprocket.
10205	PLUG	Camshaft, cylinder block rear.
10206	NOZZLE	Timing chain, oiler.
10207	SPROCKET	Camshaft, std. production VH/VK.
10208	KEY	Crankshaft damper.
10209	BOLT	Crankshaft damper.
10210	WASHER	Crankshaft damper.
10211	BOLT	Crankshaft pulley.
10212	WASHER	Crankshaft pulley bolt.
10213	PULLEY	Crankshaft air conditioning.
10214	PULLEY	Crankshaft, single row.
10215	COVER	Engine front timing.
10216	BOLT	Front timing cover.
10217	PUMP	Water, VH to VK, heavy duty.
10218	BOLT	Water pump.
10219	BOLT	Water pump.
10220	PULLEY	Water pump.
10221	PLUG	Cyl. block welsh.
10222	PLUG	Cyl. block welsh.
10223	PLUG	Cyl. block welsh.
10224	PLUG	Cyl. block water drain.
10225	DOWEL	Cyl. head to cyl. block.
10226	DOWEL	Front timing cover to cyl. block.
10227	STUD	Cylinder head to cyl. block, short.
10228	STUD	Cylinder head to cyl. block, long.
10229	ARM, ROCKER	Std. production.
10230	PIVOT, ROCKER	Arm, std. production.
10231	BOLT	Rocker arm pivot.
10232	PUSHROD	Std. production. Not for use in A9L Group A engines, fitted with 10114 - guide plate.
10233	LIFTER ASM	Hydraulic, std. production.
10234	BOLT	Inlet manifold to cyl. head - all engines VH/VK.
10235	HOUSING	Thermostat, VH/VK.
10236	GASKET	Thermostat housing.
10237	BOLT	Thermostat housing to inlet manifold.
10238	THERMOSTAT	
10239	THERMOSTAT	
10240	HOSE	Thermostat by pass.
10241	SENDER UNIT	Water Temperature.
10242	ADAPTOR	Water temperature sender unit.
10243	PIPE ASM	Fuel, fuel pump to carburettor less
10244	PLATE	E.G.R. aperture blank off.
10245	GASKET	E.G.R. blank off plate.
10246	VALVE ASM	P.C.V.
10247	GROMMET	P.C.V. valve retaining.
10248	HOSE	P.C.V. valve to character.
10249	BLOCK ASM	Cylinder 304/308, with main bearing caps.
10250	BOLT	Main bearing cap.
10251	CAP	Main bearing, front.

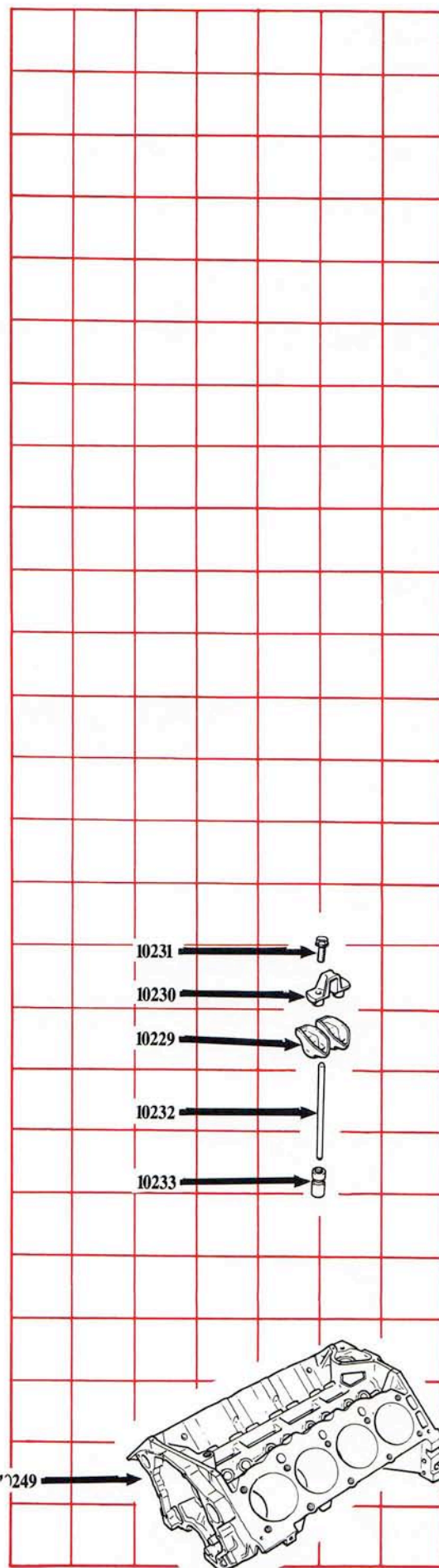

10252	CAP	Main bearing, intermediate.
10253	CAP	Main bearing, rear.
10254	BOLT	Flywheel to crankshaft, manual trans.
10255	BUSH	Crankshaft pilot.
10256	DOWEL	Clutch housing to cylinder block, locating.
10257	BOLT	Clutch pressure plate cover to flywheel.
10258	TUBE	Dip stick.
10259	DIP STICK	Engine oil
10260	SEAL	Dip stick tube 'O' ring.
10261	BOLT	Dip stick tube to cylinder block.
10262	COIL	Ignition, electronic.
10263	BRAK CET ASM	Ignition coil, retention.
10264	CYLINDER HEAD	Changeover, Big Valve. Not available for domestic use.
10265	ENGINE ASM	VK A9L Group A short.
10266	ENGINE ASM	VK A9L Group A long.
10267	ENGINE ASM	VK A9L Group A complete.
10268	OIL FILTER	Suit all 253/304/308 Holden V8 engines.
10269	GASKET	Inlet manifold, LH, VC to VK V8.
10270	GASKET	Inlet manifold, RH ⁴ VC to VK V8.
10271	RETAINER	Inlet manifold to cylinder head, locating.
10272	SEAL	Inlet manifold to cylinder block, front.
10273	SEAL	Inlet manifold to cylinder block, rear.
10274		
10275	SUPPORT ASM	Big Bore intermediate muffler to body. Asm made up of 10275A, 10276, 10277, & 10278.
10275A	NUT	
10276	ARM	Support, upper.
10277	ISULATOR	Connecting, supports.
10278	ARM	Support, lower.
10279	OIL FILTER	VL 6 cylinder.
10280	PLATE	Crankshaft damper retention, VL GP.A.
10281	BOLT	Damper retention plate, VL Group A.
10282	NUT	Damper retention plate, VL Group A.
10283	CAP	Main bearing, steel 2 bolt, VL Group A.
10284	PUSHROD	Case hardened, larger diameter than standard or VK Group A unit. Must only be used with 10285. Standard equipment VL Group A.
10285	GUIDE PLATE	Pushrod, for use only with 10284 pushrod 10113 stud. Std. equipment VL Group A.
10286	HEADER SET	VL Group A, in stainless steel, complete with connecting pipes to catalytic convertor.
10287	HEADER	LH primary, VL Group A, with companion flange plate.
10288	HEADER	RH primary, VL Group A, with companion flange plate.
10289	CONNECTING PIPE	LH, secondary collector to convertor. VL Group A.
10290	CONNECTING PIPE	RH, secondary collector, VL Group A.
10290A	GASKET	Fits between 10290/10291.
10291	CONNECTING PIPE	RH, 10290 to E.F.E. valve, VL Group A.
10292	MUFFLER ASM	Intermediate, VL Group A.
10293	MUFFLER ASM	Rear, with tailpipe, VL Group A.
10294	CLAMP ASM	Over axle exhaust pipes, VL Group A.
10295	COLD AIR SYSTEM	Complete, VL Group A, comprises:
10296	AIR CLEANER ASM	VL Group A, with chrome cover & decal.
10297	BOX ASM	Plenum chamber, cold air, VL Group A.
10298	HOSE	Connecting, plenum box to 10299, 10299 to 10300, VL Group A.

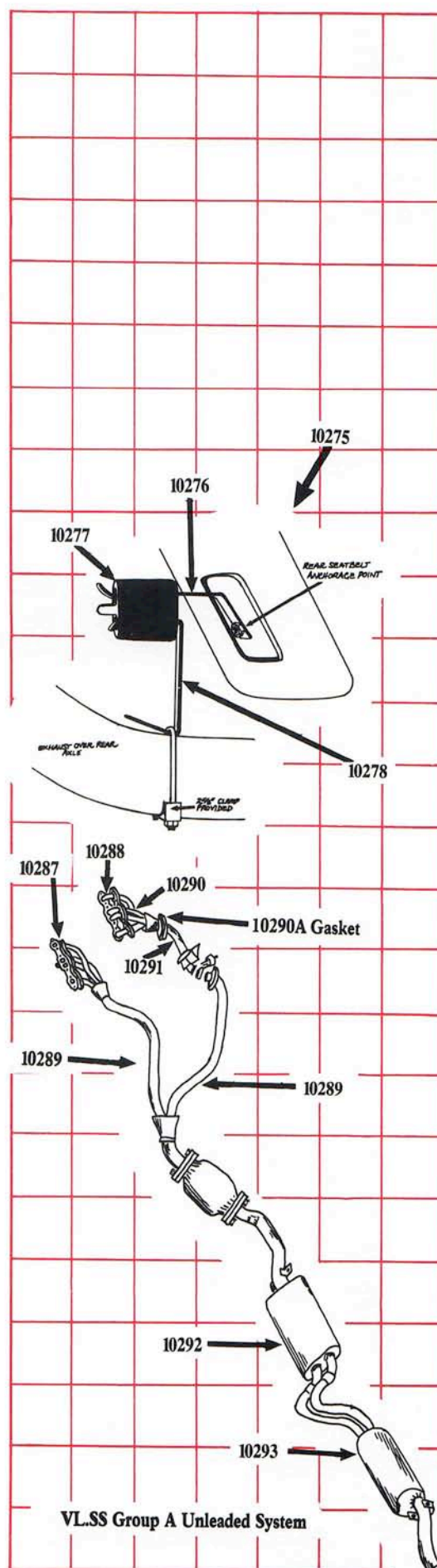

10299	NOZZLE	Air cleaner "T", VL Group A.
10300	DUCT	Chassis rail, cold air pick up, VL Group A.
10301	CLAMP	Hose, 10297 (x 4), VL Group A.
10302	INLET MANIFOLD	VL Group A (A9L) with revised E.G.R. porting.
10303	ROLLER ROCKER	Crane set, revised part with H.D. ARM SET bearings & roller pin. Homologated for VL Group A. Set is complete with locknuts. Use with 10113.
10304	ROCKER ARM	Unit as individual part without locknut. Lock, roller rocker arm, VL Group A.
10305	NUT	Lock, roller rocker arm, VL Group A.
10306	MUFFLER ASM	VL Turbo 6, big bore, intermediate.
10307	MUFFLER ASM	VL Turbo 6, big bore, rear.

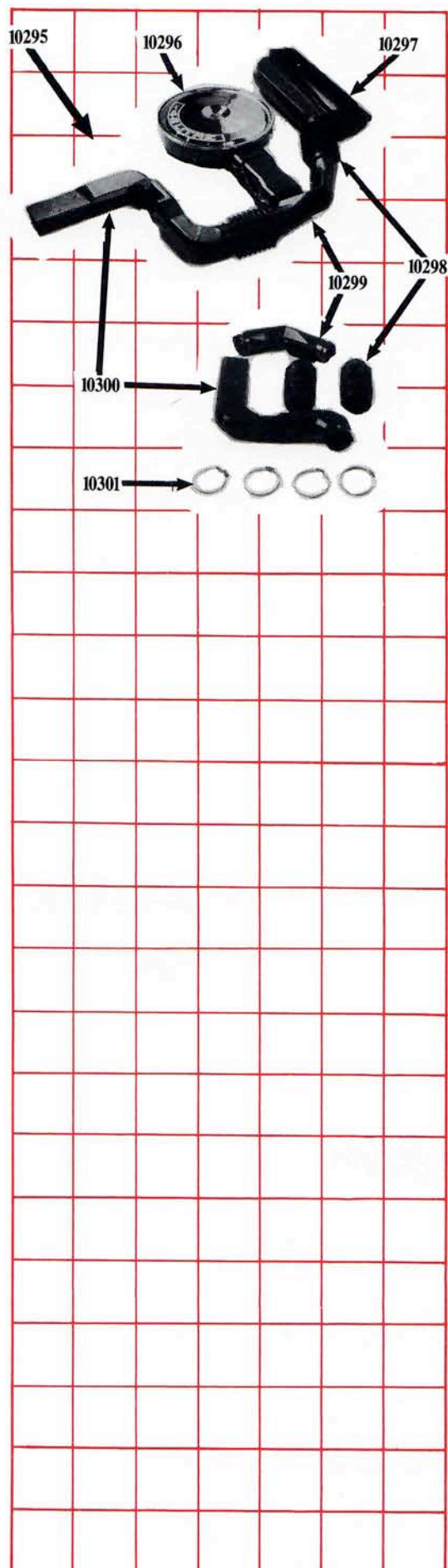



Transmission Group

TRANSMISSION GROUP

Transmission 1

20000	TRANS-MISSION KIT	HDT T5 5 speed conversion package complete for converting 4.2 & 5.0 litre Commodore 4 speed to 5 speed. Kit is complete with all necessary parts with exception of tailshaft which requires the front shaft shortened 3" and rebalanced. Must be used with 3.08 final drive. VB to VK only. For VL, use 20109.
20001	TRANS-MISSION ASM	HDT T5 5 speed unit complete with shifter asm. Ratios: 1st: 2.95/ 2nd: 1.94/ 3rd: 1.34/ 4th: 1.0/ 5th: .73.
20002	CLUTCH HOUSING	HDT 5 speed, for use with all Trimatic and manual bolt pattern 4.2 & 5.0 litre engine Commodore cylinder blocks. Can be used also with BW T10 transmissions. For Group A racing, to be used with 20030/1, 20040 & 20043. Std. equipment VL Group A.
20003	SPEEDO CABLE	For use with 5 speed transmission.
20004	SPEEDO GEAR	HDT 5 speed. For use only with 3.08 final drive ratio.
20005	GUIDE/ SPEEDO	HDT 5 speed. Locates speedo gear (20004) in transmission rear housing.
20006	'O' RING	HDT 5 speed 'O' ring seal for speedo guide (20005).
20007	ADAPTOR	HDT 5 speed. Adapts speedo guide to cruise control (Calais) drive unit.
20008	BUSH GEAR LEVER	HDT 5 speed. Connect shift lever to external selector shaft.
20009	SHIFT LEVER	HDT 5 speed. Connects 20008 to 20013. For replacement, use 20114 & 20115.
20010A	GEAR KNOB	HDT 4 speed woodgrain unit. Standard equipment VC HDT; VH Group 3 Commodore. Suit all 4 speed Commodores.
20011	DECAL	HDT 4 speed woodgrain.
20012	GEARKNOB	HDT 4 speed moulded. Standard equipment VK "SS" and Group 3. Suit all earlier models.
20013	GEARKNOB	HDT 5 speed, moulded.
20014	ADAPTOR	HDT 5 speed rear gearbox mount adaptor wedge. Adapts rear gearbox mount to gearbox.
20015	BOLT	HDT 5 speed. Transmission to clutch housing x 4.
20016	WASHER	HDT 5 speed. To be used with 20015 (x 4).
20017	CAP SCREW	HDT 5 speed. For use with 20014 (x 2).
20018	CROSS-MEMBER	HDT 5 speed. Transmission rear. N.L.A., use 20052.
20019	MOUNT	HDT 5 speed. Rear gearbox situated between 20014 & 20018.
20020	INSULATION	Clutch cable insulation stripping. Used all HDT manual vehicles when fitted with exhaust headers.
20021	CABLE ASM	HDT 5 speed. Clutch.
20022	SHAFT ASM	HDT 5 speed. Propeller shaft complete.
20023	PLATE	HDT 5 speed. Locates 20005.
20024	BOLT	HDT 5 speed. Locator plate (20023).
20025	WASHER	Use with 20024.
20026	COVER	HDT 5 speed. Interior console surround. All models to VK. Colour - Cerulean only.
20027	PLATE	HDT 5 speed. Gearlever boot sandwich. All models to VK.
20028	COVER	HDT 5 speed. Clutch fork, cable to clutch housing.
20029	INSULATION	HDT 5 speed, console boot. All models to VK.
20030	TRANS-MISSION ASM	Getrag 5 speed, Group A racing.
20031	TRANS-MISSION ASM	Getrag 5 speed, converted with Group A race gear set.
20032	GEAR SET	Getrag, Group A race.
20033	GEAR SET	Getrag, Group A race cluster complete.
20034	GEAR	Getrag, 4th cluster.
20035	GEAR	Getrag, constant mesh, cluster.
20036	SHAFT	Getrag, input.
20037	GEAR	Getrag, 2nd.
20038	GEAR	Getrag, 3rd.
20039	GEAR	Getrag, 4th.

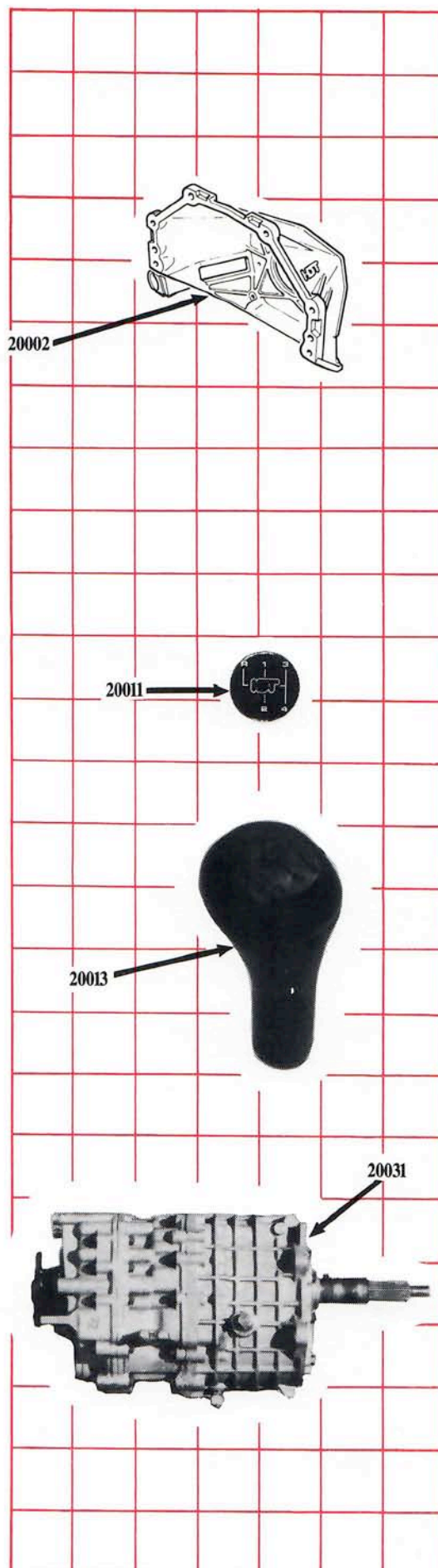

20040	PLATE	Getrag, adapts 20030/31 transmission to 20002 clutch housing.
20041	TAILSHAFT ASM	Getrag, Group A.
20042	FLANGE	Getrag, tailshaft front.
20043	SPACER	Getrag, clutch housing to transmission.
20044	BEARING ASM	Getrag, clutch thrust.
20045	LEVER ASM	Getrag, shift.
20046	COUPLING	Getrag, gear shift rod to gearbox selector shaft.
20047	CIRCLIP	Getrag, shift lever.
20048	CUP	Getrag, shift lever nylon locator.
20049	PIN	Getrag, locates 20046 to selector shaft.
20050	RING	Getrag, synchro.
20051	GASKET SET	Getrag, complete.
20052	CROSS-MEMBER	HDT T5 rear, second design, suit all Commodores to VK.
20053	OIL SEAL	Getrag, rear.
20054	OIL SEAL	Getrag, selector shaft.
20055	BEARING	Getrag, mainshaft spigot.
20056	BEARING	Getrag, reverse shaft needle roller.
20057	BEARING	Getrag, mainshaft rear needle roller (small).
20058	BEARING	Getrag, mainshaft needle roller (large, 4 per unit).
20059	BEARING	Getrag, mainshaft rear & cluster gear rear.
20060	BEARING ASM	Getrag, mainshaft centre roller & sleeve.
20061	BEARING	Getrag, cluster gear front.
20062	CABLE ASM	Speedo, VK Calais when fitted with T5 transmission.
20063	BEARING	Getrag, input shaft.
20064	FLANGE	Getrag, rear output drive.
20065	NUT	Getrag, output flange.
20066	LOCKPLATE	Getrag, output flange unit.
20067	BEARING	
20068	GASKET	Getrag, front seal housing.
20069	GASKET	Getrag, gear case, intermediate.
20070	GASKET	Getrag, gearcase, rear.
20071	HOUSING	Getrag, front oil seal.
20072	HOUSING	Getrag, gearcase, front.
20073	HOUSING	Getrag, gearcase, intermediate.
20074	HOUSING	Getrag, gearcase, rear.
20075		
20076		
20077	SHAFT	Getrag, 1st/Reverse, selector.
20078	SHAFT	Getrag, 2nd/3rd, selector.
20079	SHAFT	Getrag, 4th/5th, selector.
20080	SHAFT	Getrag, main selector.
20081	FORK	Getrag, 1st/Reverse, selector.
20082	FORK	Getrag, 2nd/3rd, selector.
20083	FORK	Getrag, 4th/5th, selector.
20084	CUP	Getrag, selector shaft (3), housing blank off.
20085	CUP	Getrag, selector shaft (1), housing blank off.
20086	KEEPER	Getrag, mainshaft centre bearing.
20087	LOCKRING	Getrag, input shaft bearing.
20088	KEEPER	Getrag, input shaft bearing.
20089	CIRCLIP	Getrag, input shaft bearing.
20090	SHIM	Getrag, mainshaft rear bearing.
20091	WASHER	Getrag, spigot bearing.
20092	SPRING LEVER	Getrag, reverse gear.
20093	LEVER	Getrag, reverse gear selector.
20094	KEEPER	Getrag, reverse gear locknut.
20095	SELECTOR	Getrag, reverse gear.
20096	BOLT	Getrag, reverse gear selector locator.
20097	GEAR	Getrag, 1st speed cluster.
20098	GEAR	Getrag, 1st speed mainshaft.
20099	SHAFT	Getrag, main.
20100	HUB ASM	Getrag, front synchro.



20101	HUB ASM	Getrag, intermediate synchro.
20102	HUB ASM	Getrag, rear synchro.
20103	HOUSING	Getrag, interlock selector.
20104	SPRING	Getrag, interlock detent.
20105	PLUG	Getrag, oil filler.
20106	PLUG	Getrag, oil drain.
20107	CROWN-WHEEL & PINION	3.08 heavy duty axle, std. equipment all 5.0 manual transmission HDT cars, to VK.
20108	L.S.D. UNIT	3.08 heavy duty axle. Same application as 20107.
20109	TRANS-MISSION KIT	HDT 5 speed installation package complete, for converting VL V8 automatic transmission to manual. Package is complete with transmission assembly, flywheel, clutch asm, manual pedal box asm and all hardware. VL tailshaft/ front shaft, requires to be shortened 3" (74.1mm) and rebalanced (not part of installation package). HDT 5 speed rear, VL Group A - on.
20110	CROSS-MEMBER	
20111	HEAT SHIELD	HDT 5 speed, rear mount, VL Group A.
20112	HARNESS ASM	HDT 5 speed, reverse light, VL Group A.
20113	SWITCH	HDT 5 speed, reverse light, VL Group A.
20114	LEVER	HDT 5 speed, gear shift, VL Group A.
20115	GEAR KNOB	HDT 5 speed, Momo, VL Group A. Also suit all VL 6 cylinder manuals.
20116		
20117	RETAINER PLATE	Transmission tunnel, for HDT T5, Std. equipment VL Group A.
20118	COVER	T5 transmission gear case top plate.
20119	SEAL	T5 'O' ring, cover plate to extension housing shift rail.
20120	RAIL	T5 shift.
20121	INSERT	T5 shift forks, 1-2, 3-4, 5.
20122	PIN	T5 spring.
20123	SPRING	T5 synchro, 1-2, 3-4.
20124	SHAFT ASM	T5 output, including synchro asm and sliding gear.
20125	RING	T5 blocking, 1st & 2nd synchro.
20126	GEAR	T5 1st speed, 32T.
20127	WASHER	T5 thrust, 1st speed gear.
20128	CONE	T5 bearing, output shaft.
20129	CUP	T5 bearing, output shaft.
20130	GEAR	T5, 5th speed, driven 31T.
20131	RING	T5 snap, 5th gear.
20132	GEAR	T5 speedo drive.
20133	ROLLER	T5 needle, input shaft.
20134	BEARING	T5 needle thrust.
20135	PLATE	T5 thrust needle bearing.
20136	RING	T5 blocking, 3rd & 4th.
20137	PLATE	T5 shifter, 3rd & 4th synchro.
20138	SYNCHRO ASM	T5, 3rd & 4th.
20139	GEAR	T5, 3rd speed, 30T.
20140	RING	T5 snap, 2nd speed gear.
20141	WASHER	T5 thrust, 2nd speed gear.
20142	GEAR	T5, 2nd speed, 33T.
20143	PLATE	T5 shifter, 1st & 2nd synchro.
20144	BEARING	T5 cluster, front.
20145	WASHER	T5 thrust, cluster.
20146	GEAR	T5 cluster 31,29,22,15,14 teeth
20147	SPACER	T5 cluster to rear bearing.
20148	BEARING	T5 cluster, rear.
20149	SPACER	T5 cluster, rear bearing to 5th drive gear.
20150	RING	T5 snap, 5th speed.
20151	GEAR	T5, 5th speed drive, 55T.
20152	RING	T5 blocking, 5th speed.

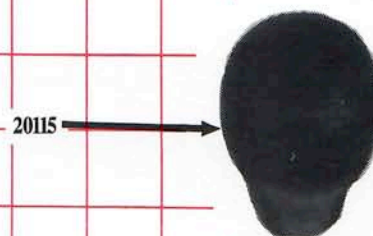

This image shows a full page of blank graph paper. The grid consists of thin red lines forming small squares across the entire surface. There are no margins, text, or other markings on the paper.



Suspension Group

SUSPENSION GROUP

Suspension 1

COMPRISING: FRONT & REAR SUSPENSION, BRAKES, STEERING

30000	CARTRIDGE/ STRUT	Bilstein gas front strut insert. Std. equipment VC HDT Commodore, VH "SS" Group 3 and other HDT Improved vehicles. N.L.A.
30001	SHOCK ABSORBER	Rear Bilstein gas. Covers same model range as 30000. For fitment to all Commodore sedans only. Std. equipment VK LM5000. N.L.A.
30002	SHOCK ABSORBER	Rear Bilstein gas. HDT settings suit all model Commodore wagons.
30003	MOUNT/ SRUT	Heavy duty front strut top bearing mount. Used in all HDT modified Commodores when heavy duty suspension is required. Suit all model Commodores with and without modified suspension. Must be used with 30028
30004	SPRING/ FRONT	High performance unit with revised rate. Exclusive to HDT. Suit all model Commodore 4.2/5.0L sedan & wagons. Std. equipment late '83 VH "SS" Group 3 and LM5000, all HDT Improved vehicles, VK "SS" and Group 3.
30005	SPRING/ REAR	High performance unit with revised rate. Exclusive to HDT. Suite same model as 30004. For use Commodore sedans only.
30006	SPRING/ REAR	High performance unit with revised rate. For Commodore wagon use only, all models. Use with 30002.
30007	SWAY BAR/ FRONT	A 26mm unit to HDT specifications. Std. equipment VH/VK "SS" and all HDT Improved Commodore sedans and wagons. Suit all model Commodore.
30008	INSULATOR	Front sway bar (26mm) to body mount. Must be used in conjunction with 30007.
30009	SWAY BAR/ REAR	A 14mm unit to HDT specifications. Suit same applications as 30007 (sedan only).
30010	INSULATOR	Rear sway bar (14mm) to body mount. Must be used with 30009.
30011	SWAY BAR/ FRONT	A 27mm unit to HDT specifications. Std. equipment VK "SS" Group 3, VK Group A. Must be used only with 16" rims. Will suit all model Commodore.
30012	INSULATOR	For use with front sway bar (27mm) 30011.
30013	SWAY BAR/ REAR	A 16mm unit.
30014	SWAY BAR KIT	Rear. For use on Commodore wagons, all models. This is a complete kit of parts. Brackets are supplied for welding to rear axle housing and body.
30015	BUSH/HEAVY DUTY	Rear axle lower control arm front. Suit all model Commodore sedans and wagons. Std. equipment all HDT cars.
30016	BUSH/HEAVY DUTY	Rear axle upper control arm front & rear. Same application as 30015.
30017	BUSH/HEAVY DUTY	Front suspension, lower control arm inner. Suit all model Commodore sedan and wagons. Std. equipment all HDT cars.
30018	SHOCK ABSORBER	Front, Bilstein gas. Exclusive to HDT for Statesman Magnum. Suit all WB Statesman and earlier HQ derivatives.
30019	SHOCK ABSORBER	Rear, Bilstein gas. Exclusive to HDT for Statesman Magnum. Same application as 30018.
30020	SPRING/ FRONT	High performance unit made exclusively to HDT specifications for use on all Statesman Magnum. Suit earlier WB models and pre-WB models.
30021	SPRING/ REAR	Same applications as 30020 (Statesman Magnum, etc.)
30022	SWAY BAR/ FRONT	A 27mm unit made to HDT specifications for exclusive use on Statesman Magnum. Will suit earlier models.
30023	INSULATOR	For use with 30022 (27mm sway bar).
30024	BUSH/HEAVY DUTY	Front suspension lower control arm inner, Statesman Magnum. Will suit earlier models. N.L.A.

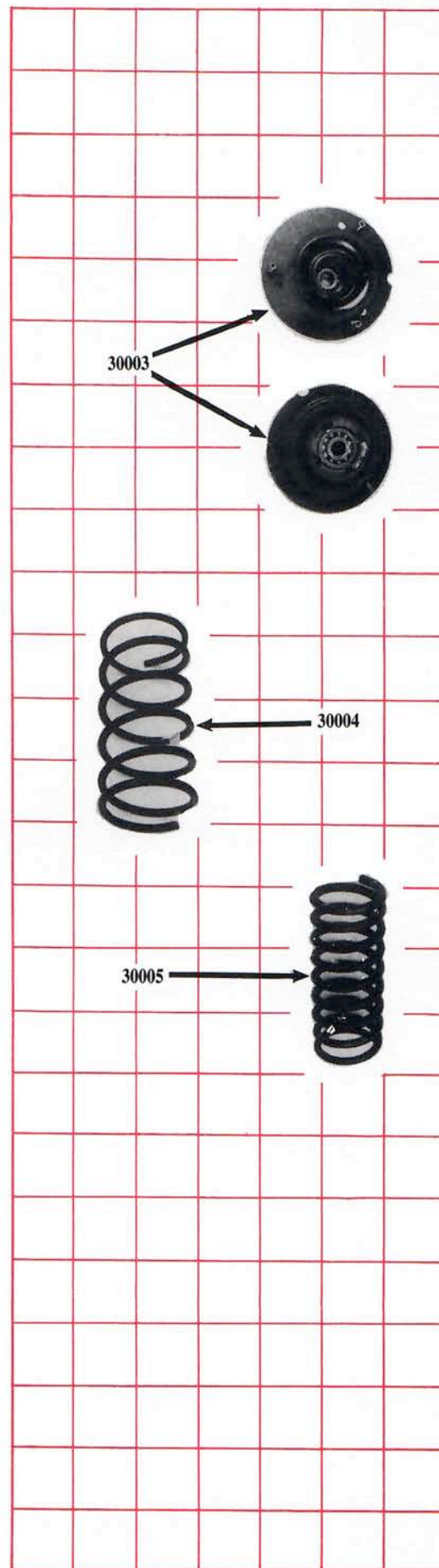

- 30025 SHOCK ABSORBER** Front, Bilstein gas. For fitment to Jackaroo, all models. N.L.A.
- 30026 SHOCK ABSORBER** Rear, Bilstein gas. For fitment to Jackaroo, all models. N.L.A.
- 30027 MASTER CYLINDER** Heavy duty 1" unit. Std. equipment all HDT modified Commodores (sedans & wagons).
- 30028 CARTRIDGE/STRUT** Bilstein gas front strut insert. Exclusive to HDT. Revised settings and construction. Std. equipment VK "SS" Group 3. Suit all model Commodore. Must be used in conjunction 30003 & 30004.
- 30029 SHOCK ABSORBER** Rear, Bilstein gas. Exclusive to HDT. With revised rating and construction. Std. equipment VK "SS" Group 3. Must be used with 30005. Suit all model Commodore sedan.
- 30030 KIT SUSPENSION** Complete for all model V8 Commodore sedans to VL. Kit is complete with:
 30003 Strut mounts
 30004 Front springs
 30005 Rear springs
 30007 26mm front sway bar
 30008 26mm insulation
 30009 14mm rear sway bar
 30010 14mm insulator
 30034 Axle bracket nuts
 30035 Axle bracket bolts
 30036 Rear bar studs
 30037 Rear bar nuts
 30038 " " washers
 30039 " " bushes
 30040 " " bushes
 30041 " " brackets
 30044 Bilstein inserts
 30045 Bilstein rear shock absorbers
- 30031 KIT SUSPENSION** Complete for all model V8 Commodore sedans to VL. Kit is complete as 30030 with the exception that 30044/30045 replaced by
- 30032 KIT SUSPENSION** Same as 30031 with the exception that
- 30033 N.L.A.**
- 30034 NUT** Rear sway bar axle bracket - all models VB-VK sedan.
- 30035 BOLT** Same location as 30034.
- 30036 STUD** Rear sway bar, locates bar to body - VB/VK sedan.
- 30037 NUT** Rear sway bar stud.
- 30038 WASHER** Rear sway bar stud bush.
- 30039 BUSH** Rear sway bar stud (2).
- 30040 BUSH** Rear sway bar stud (6).
- 30041 BRACKET** Rear sway bar axle.
- 30042 SHOCK ABSORBER** Bilstein front insert, std. equipment VK "SS" Group A.
- 30043 SHOCK ABSORBER** Bilstein rear, std. equipment VK Group A.
- 30044 SHOCK ABSORBER** Bilstein front insert, std. equipment - VK Calais Director VK "SS" Group 3 (Sept. '85 on) VL Calais Sport VL "SS" Group A VL Director
- 30045 SHOCK ABSORBER** Bilstein rear, std. equipment all models as in 30044 with exception of VL Director.
- 30046**

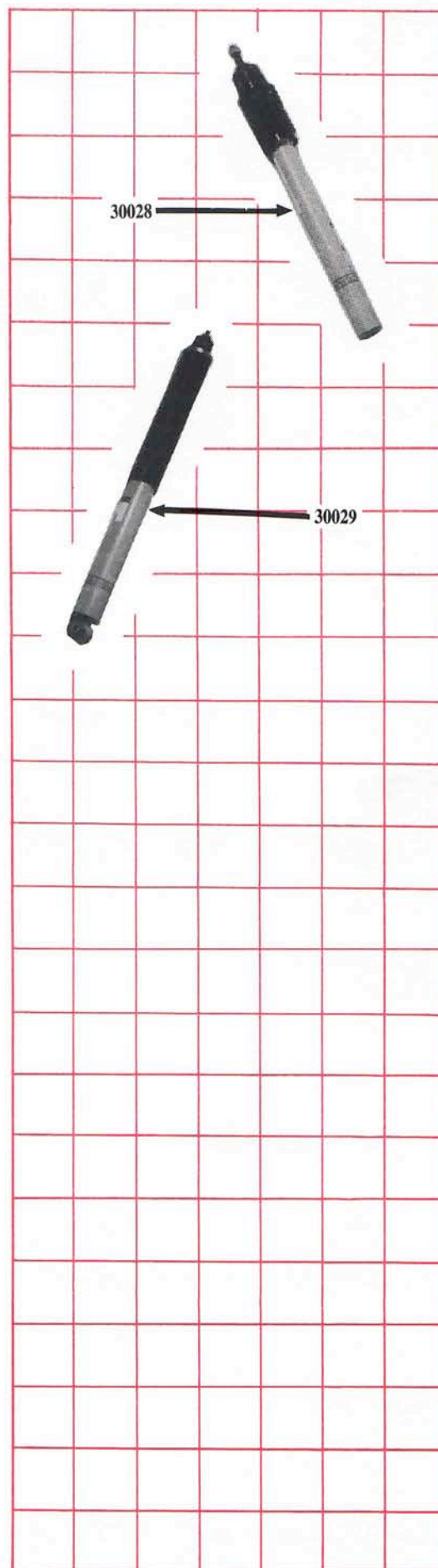



Body Group

BODY GROUP

Body 1

- 40000 BODY KIT** Complete. Standard equipment VC HDT Kit comprises: 40001, 40002, 40003, 40004, 40005, 40006, 40007, 40008. Suit all model VB/VH.
- 40001 AIR DAM** Front VC HDT commodore. Suit all model VB to VH.
- 40002 FLARE** Left hand front guard. VC HDT Commodore. Suit VB to VH.
- 40003 FLARE** Right hand front guard. VC HDT Commodore. Suit VB to VH.
- 40004 FLARE** Left hand rear door. VC HDT Commodore. Suit VB to VH.
- 40005 FLARE** Right hand rear door. VC HDT Commodore. Suit VB to VH.
- 40006 FLARE** Left hand rear quarter panel. VC HDT Commodore. Suit VB to VH.
- 40007 FLARE** Right hand rear quarter panel. VC HDT Commodore. Suit VB to VH.
- 40008 REAR SPOILER** VC HDT Commodore, 3 peice. Suit VB to VH.
- 40009 AIR DAM** Front. When not used with VC HDT Commodore guard flares. Suit VB to VH.
- 40010 BODY KIT** Complete. VH "SS" Group 3. Kit comprises: 40012, 40013, 40014, 40015, 40016, 40017, 40018. Suit VB to VH.
- 40011 BODY KIT** Complete. VH "SS" Group 3. Same as Kit 40010 but also includes 40019, 40020, 40021. Suit VB to VH.
- 40012 AIR DAM** Front. VH "SS" Group 3. Suit VC to VH.
- 40013 SIDE SKIRT** Left hand sill. VH "SS" Group 3 & LM5000. Suit VB to VK.
- 40014 SIDE SKIRT** Right hand sill. VH "SS" Group 3 & LM5000. Suit VB to VK.
- 40015 SPAT** Left hand R/door. VH "SS" Group 3 & LM5000. Suit VB to VK.
- 40016 SPAT** Right hand R/door. VH "SS" Group 3 & LM5000. suit VB TO VK.
- 40017 SKIRT** Rear underbody. VH "SS" Group 3. Suit VB to VK.
- 40018 REAR SPOILER** VH Group 3 (supported on 4 legs).
- 40018A SPOILER LEG** VH Group 3 (short x 2, long x 2).
- 40019 BONNET SCOOP** VH "SS" Group 3. Suit VB to VK.
- 40020 WINDSPLIT** Left hand front guard. VH "SS" Group 3; LM5000; VK "SS" Group 3. Suit VB to VK.
- 40021 WINDSPLIT** Right hand front guard. VH "SS" Group 3; LM5000, VK "SS" Group 3. Suit VB to VK.
- 40021A WINDSPLIT** Pair - 40020 & 40021.
- 40022 FOOTREST** Standard equipment all HDT vehicles. Suit VB to VK & Statesman Magnum. Also suit earlier model Holdens.
- 40023 STEERING WHEEL** Momo 4 spoke black. Complete assembly with ASM adaptor hub; hub boot; horn button, etc. Standard equipment VC HDT Commodore. Suit all VB to VK models. Limited supply.
- 40024 STEERING WHEEL** Momo 3 spoke black. Complete with all ASM hardware for fitting. Standard equipment VH "SS" Group 3. Suit VB to VK.
(PLEASE NOTE: During production of VH "SS" Group 3 a large number of vehicles were fitted with a red version of the 40024 Momo steering wheel. This item is N.L.A.)
- 40025 STEERING WHEEL** Momo 3 spoke black. Complete with all ASM hardware including "Peter Brock" horn button. Standard equipment all VK model HDT vehicles. Suit VB to VL.
- 40025A STEERING WHEEL** Wheel only. Same application 40025.
- 40026 HUB** Momo steering wheel, collapsible. Standard equipment on all HDT vehicles including Magnum.

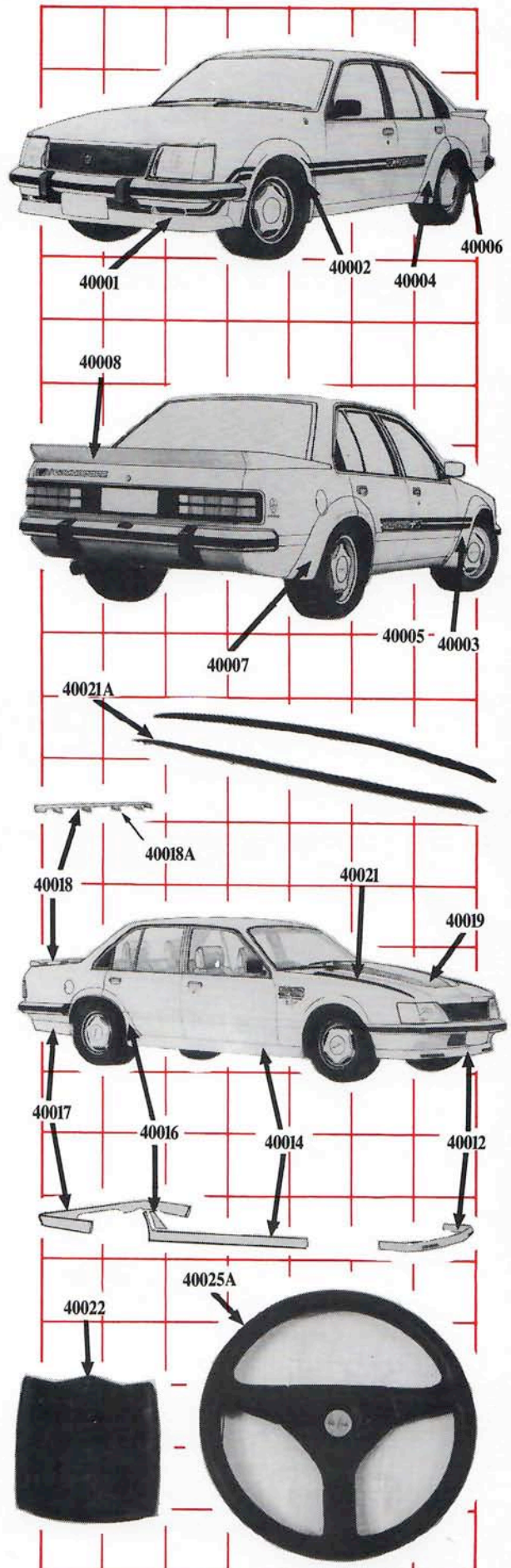

- 40027 **BOOT** Momo steering wheel hub. Standard equipment all HDT vehicles.
- 40028 **HORN BUTTON** "HDT" Standard equipment on all VC-VH HDT vehicles.
- 40029 **HORN BUTTON** "Peter Brock" Standard equipment all VK series HDT vehicles.
- 40030 **DECAL KIT** VC HDT Commodore complete body. Supply limited to genuine vehicles. Vehicle number and colour must be quoted when ordered.
- 40031A **DECAL** Air Dam front left hand. VC HDT Commodore.
- 40031B **DECAL** Air Dam front right hand. VC HDT Commodore.
- 40031C **DECAL** Air Dam to front left hand guard: semi-moon shape. VC HDT Commodore.
- 40031D **DECAL** Air Dam to front right hand guard: semi-moon shape. VC HDT Commodore.
- 40031DL **DECAL** Front LH Guard, Front
- 40031DR **DECAL** Front RH Guard, Front
- 40031E **DECAL** Left hand front guard flare front. VC HDT Commodore.
- 40031F **DECAL** Right hand front guard flare front. VC HDT Commodore.
- 40031G **DECAL** Left hand front guard flare rear. VC HDT Commodore.
- 40031H **DECAL** Right hand front guard flare rear.
- 40031I **DECAL** Left hand front guard flare to front door. VC HDT Commodore.
- 40031J **DECAL** Right hand front guard flare to front door. VC HDT Commodore.
- 40031K **DECAL** Left hand front door. VC HDT Commodore.
- 40031L **DECAL** Right hand front door. VC HDT Commodore.
- 40031M **DECAL** Left hand rear door. VC HDT Commodore.
- 40031N **DECAL** Right hand rear door. VC HDT Commodore.
- 40031O **DECAL** "CHAMPIONSHIP" left and right hand rear quarter panel. White. VC HDT Commodore.
- 40031P **DECAL** "CHAMPIONSHIP" left and right hand rear quarter panel. Black. VC HDT Commodore.
- 40031Q **DECAL** "HDT/COMMODORE" left hand side rear bootlid. White. VC HDT Commodore.
- 40031U **DECAL** "HDT/COMMODORE" left hand side rear bootlid. Black. VC HDT Commodore.
- 40032 **FUEL TANK** 90 litre. Suit all model Commodore Sedan. Standard equipment VK "SS" Group 3. Not for use in VK (or VL) EFI. Complete with extended straps.
- 40033 **FUEL TANK** 105 litre. Suit all model Commodore Wagon, except VK & VL EFI.
- 40034 **FUEL TANK** 120 Litre. Suit all model WB Statesman. N.L.A.
- 40035 **DECAL** "COMMODORE" Black. Rear bootlid. Standard equipment LM5000 & other HDT improved vehicles
- 40036 **DECAL** "COMMODORE" White. Same application as 40035.
- 40037 **DECAL** "SS" left and right hand front guard. Standard equipment 4.2 & 5.0 VH "SS" base car.
- 40038 **DECAL** "SS" rear bootlid. 4.2 & 5.0 VH "SS" base car & Group 3.
- 40039 **DECAL** "SS GROUP ONE PETER BROCK" left and right hand front guard. VH 4.2 "SS".
- 40040 **DECAL** "SS GROUP TWO PETER BROCK" left and right hand front guard. VH 4.2 "SS".
- 40041 **DECAL** "SS GROUP THREE PETER BROCK" left and right hand front guard. VH 4.2 & 5.0 Group 3.
- 40042 **PLAQUE** "HDT COMMODORE" glovebox. Vehicle number to be quoted with order. Standard equipment VC HDT Commodore.
- 40043 **MOULD** "HDT IMPROVED" glovebox strip.
- 40044A **MOULD** "SS GROUP ONE" glovebox strip. VH "SS".
- 40044B **MOULD** "SS GROUP TWO" glovebox strip. Standard equipment VH "SS".
- 40044C **MOULD** "SS GROUP THREE" glovebox strip. Standard equipment VH "SS".
- 40044D **MOULD** "HDT IMPROVED SLE" glovebox strip. Standard equipment VH HDT improved SLE.

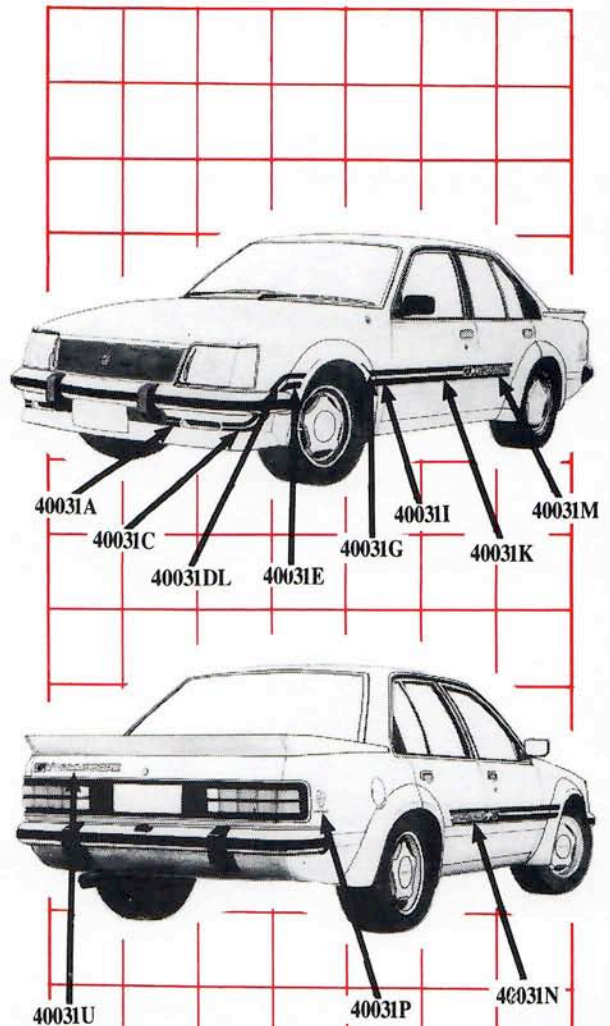

- 40044E **MOULD** Glovebox strip. Black. Standard equipment VK "SS" & Group 3.
- 40045 **STEERING WHEEL** Momo Gritti. Standard equipment Statesman "Magnum" complete with adaptor hub; horn button; boot hub. Suit all WB Statesman & earlier.
- 40046 **DECAL** "MAGNUM" Standard equipment WB Statesman. Quote vehicle number with order.
- 40047 **STEERING WHEEL** Momo. Fitted to HDT improved Jackaroo. Complete with adaptor hub; "HDT" horn button; hub boot.
- 40048 **STEREO SYSTEM** VH "SS GROUP ONE" complete. N.L.A.
- 40049 **STEREO SYSTEM** VH "SS GROUP TWO" complete. N.L.A.
- 40050 **STEREO SYSTEM** VH "SS GROUP THREE" complete. N.L.A.
- 40051 **AERIAL ASM** VH "SS" Electric. Black mast. Complete.
- 40052 **HEADLIGHT GLOBE** 100/90W quartz halogen. (100 watt high beam/90W low beam.) Suit VB to VK & WB Statesman. Will also suit earlier models. Must be used with H/D relay harness asm.
- 40053 **HEADLIGHT GLOBE** 130/90W quartz halogen. (130 watt high beam/90 watt low beam.) Same application as 40052. Must be used with H/D relay harness asm.
- 40054 **GLOBE** 100W driving light. Suit WB Statesman.
- 40055 **H/LIGHT COVERS** Tinted. Suit VB/VC. N.L.A.
- 40056 **H/LIGHT COVERS** Tinted. Suit VH/VK. N.L.A.
- 40057 **H/LIGHT COVERS** Tinted. Suit WB Statesman. N.L.A. (PLEASE NOTE: Tinted headlight covers are for vehicle display purposes only and are illegal for night use.)
- 40058 **DECAL** "PETER BROCK" signature. Standard equipment VK LM5000. Quote vehicle build number when ordering.
- 40059 **DECAL** Australian Flag. Standard equipment VK LM5000. Quote vehicle build number when ordering.
- 40060 **DECAL** "HDT IMPROVED" Not for general sale. Quote vehicle tag or build number when ordering.
- 40061 **DECAL** "HDT WE BUILD EXCITEMENT" Not for general sale. Standard equipment late production VK LM5000 & all other HDT VK models & WB Statesman Magnum. Quote vehicle build number when ordering.
- 40062 **MOULD** Headlight surround left hand. Standard equipment VK HDT vehicles. Also suit VH.
- 40063 **MOULD** Headlight surround right hand. Same application as 40062.
- 40063A **MOULD** Pair (40062 & 40063).
- 40064 **BADGE** "5.0" Litre. Standard equipment VK LM5000.
- 40065 **I.D PLATE** Identification plate fixed to all HDT vehicles VK - on. Plate states vehicle build number, vehicle and build date. Commodore plate location is left hand side on firewall and left hand top side of scuttle on WB Magnum. The fixing of this plate ensures a genuine HDT built vehicle. Not for general sale.
- 40066 **SIDE SKIRT** Left hand sill. VK "SS" option. Suit VB/VC/VH and Calais.
- 40067 **SIDE SKIRT** Right hand sill. VK "SS" option. Same application as 40066.
- 40068 **REAR SPOILER** VK "SS". Suit all model Commodore Sedan.
- 40069 **PLAQUE** VK "SS" & Group 3. Instrument panel ctr.
- 40070 **DECAL KIT** Complete exterior body. Standard equipment VK "SS". Quote build number with order.
- 40071 **DECAL** "SS" front grille & rear bootlid. VK "SS" & Group 3. Quote build number with order.
- 40072 **DECAL** Left hand front guard stripe, indicator lens to wheel arch VK "SS". Quote build number with order.
- 40073 **DECAL** Right hand front guard. Same as 40072. Quote build number with order.

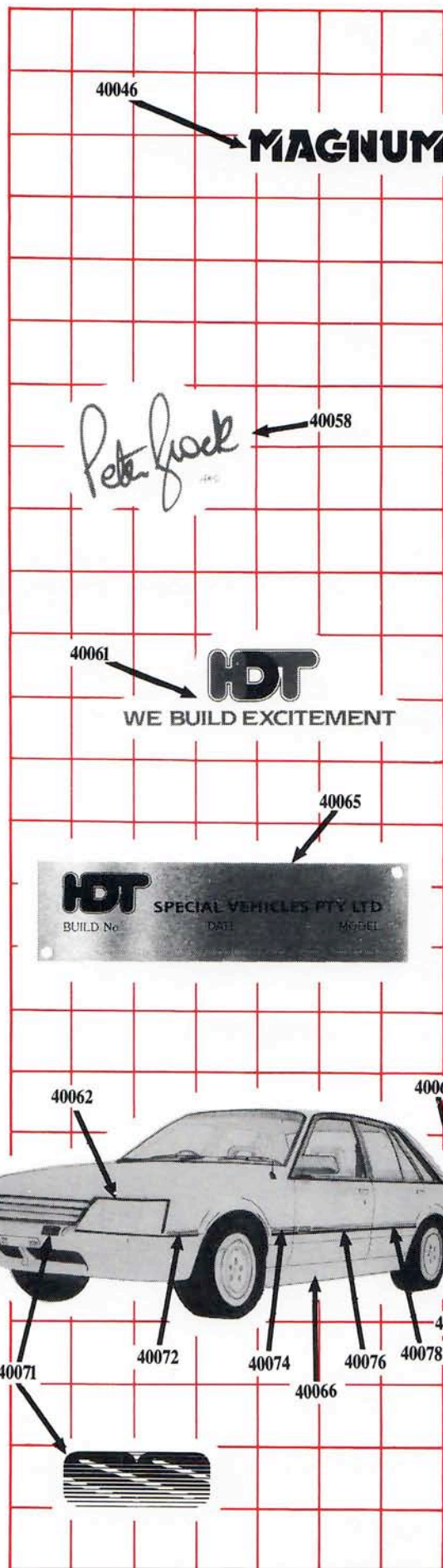

- | | | |
|--------|---------------|-----------------------------------------------------------------------------------------------------------|
| 40074 | DECAL | Left hand front guard stripe, wheel arch to door. VK "SS". Quote build number with order. |
| 40075 | DECAL | Right hand front guard. Same as 40074. Quote build number with order. |
| 40076 | DECAL | Left hand front door stripe. VK "SS". Quote build number with order. |
| 40077 | DECAL | Right hand front door stripe. VK "SS". Quote build number with order. |
| 40078 | DECAL | Left hand rear door stripe. VK "SS". Quote build number with order. |
| 40079 | DECAL | Right hand rear quarter stripe. VK "SS". Quote build number with order. |
| 40080 | DECAL | Left hand rear quarter stripe. VK "SS". Quote build number with order. |
| 40081 | DECAL | Right hand rear quarter stripe. VK "SS". Quote build number with order. |
| 40082 | BODY KIT | Complete exterior. VK "SS" Group 3 incl. bonnet scoop and windsplits. |
| 40083 | BODY KIT | Same as 40082 excluding bonnet scoop and windsplits. |
| 40084A | AIR DAM | Front. VK "SS" Group 3. |
| 40084B | GRILLE | Front. VK "SS" Group 3. |
| 40085 | SIDE SKIRT | Left hand sill. VK "SS" Group 3. |
| 40086 | SIDE SKIRT | Right hand sill. VK "SS" Group 3. |
| 40087 | DOOR SPAT | Left hand rear. VK "SS" Group 3. |
| 40088 | DOOR SPAT | Right hand rear. VK "SS" Group 3. |
| 40089 | REAR SPOILER | VK "SS" Group 3. |
| 40090 | REAR SKIRT | VK "SS" Group 3. |
| 40091 | DECAL | "SS GROUP THREE PETER BROCK". VK Group 3. Left and Right hand front guard. Quote build number with order. |
| 40092 | DOOR TRIM | Left hand front interior. VK "SS" and Group A. |
| 40093 | DOOR TRIM | Right hand front interior. VK "SS" and Group A. |
| 40094 | ARMREST | Left hand front door. VK "SS" & Group 3. |
| 40095 | ARMREST | Right hand front door. VK "SS" & Group 3. |
| 40096 | DOOR TRIM | Left hand rear interior. VK "SS" & Group A. |
| 40097 | DOOR TRIM | Right hand rear interior. VK "SS" & Group A. |
| 40098 | SEAT ASM | Scheel. Left hand front complete with adaptor frame; height adjuster; side cover. VK "SS" and Group A. |
| 40099 | SEAT ASM | Scheel. Right hand front complete as 40098. |
| 40100 | SEAT ASM | Scheel. Left hand front complete. VK "SS" Group 3. |
| 40101 | SEAT ASM | Scheel. Right hand front complete. VK "SS" Group 3. |
| 40102 | ADAPTOR PLATE | Scheel. Left hand front seat to seat height adjuster and runners. All VK "SS". |
| 40103 | ADAPTOR PLATE | Scheel. Right hand front seat to seat height adjuster and runners. All VK "SS". |
| 40104 | COVER | Front left hand seat height adjuster. All VK "SS". |
| 40105 | COVER | Front right hand seat height adjuster. All VK "SS". |
| 40106 | COVER | Left hand front seat height adjuster lever. All VK "SS". |
| 40107 | SEAT CUSHION | Rear. All VK "SS". |
| 40108 | BACKREST | Rear Seat. VK "SS" & Group A. |
| 40109 | BACKREST | Rear Seat. VK "SS" Group 3. |
| 40110 | HEADREST | Rear Seat. VK "SS" Group 3. |
| 40111 | BRACKET | Rear seat headrest to body mount. VK "SS" Group 3. |
| 40112 | RETAINER | Rear seat headrest leg. Fits into body mount bracket (40111) to retain headrest legs. VK "SS" Group 3. |
| 40113 | CARPET ASM | Front & rear cut pile moulded. VK "SS" Group 3. |
| 40114 | CARPET ASM | Boot floor. VK "SS" Group 3. |
| 40115 | WHEEL COVER | Spare. Carpeted. VK "SS" Group 3. |
| 40116 | DOOR TRIM | Left hand front interior. VK "SS" Gp 3. |
| 40117 | DOOR TRIM | Right hand front interior. VK "SS" Gp 3. |
| 40118 | DOOR TRIM | Left hand rear interior. VK "SS" Gp 3. |
| 40119 | DOOR TRIM | Right hand rear interior. VK "SS" Gp 3. |

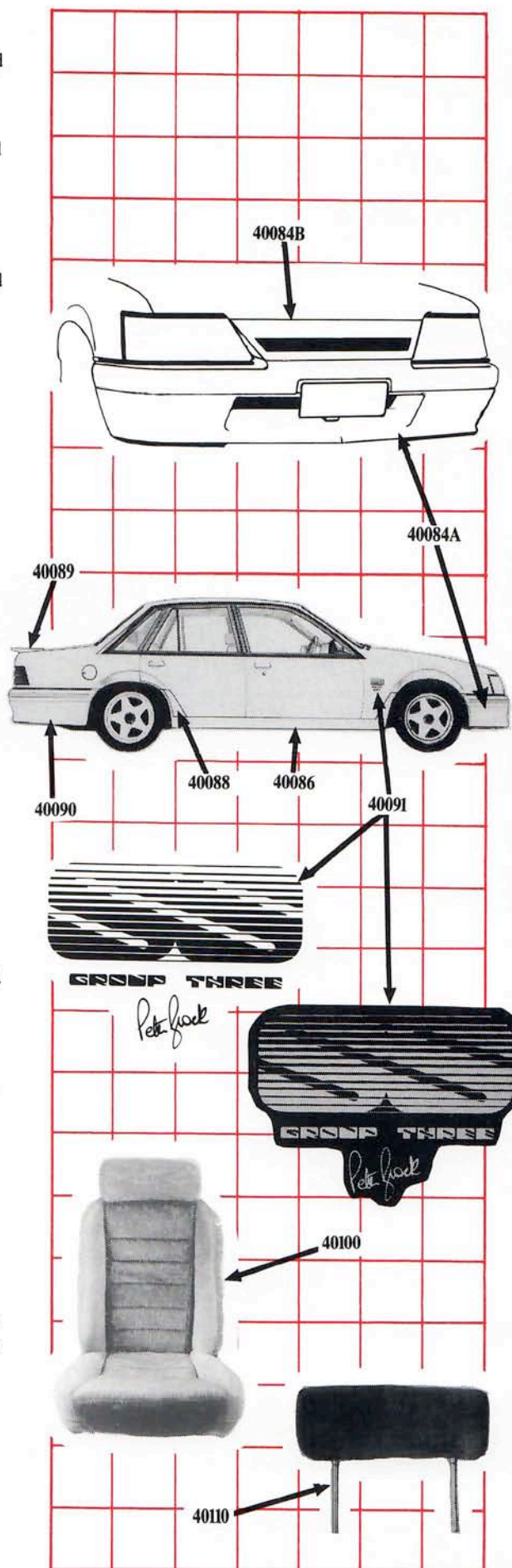

40120	KICK PANEL	Left hand front. VK "SS" Group 3. Deleted late Feb. '85.
40121	KICK PANEL	Right hand front. VK "SS" Group 3. Deleted late Feb. '85.
40122	WEATHER-STRIP	Left hand front door. VK "SS" Group 3.
40123	WEATHER-STRIP	Right hand front door. VK "SS" Group 3.
40124	PARCEL SHELF	Rear. Carpeted. VK "SS" Group 3.
40125	AERIAL ASM	Black. Manual operation, complete, VK "SS". N.L.A.
40126	BEZEL & SEAL	Black. Manual aerial asm. VK "SS".
40127	SOUND SYSTEM	"PETER BROCK" complete. VK "SS" Group 3.
40128	GRILLE	Left & right hand front speaker. VK "SS" Group 3.
40129	GRILLE	Left & right hand rear speaker. VK "SS" Group 3.
40130	ALARM SYSTEM	HDT Anti-Theft. Complete. VK "SS" Gp 3.
40131	HARNESS ASM	HDT Anti-Theft alarm system wiring. Complete. VK "SS" Group 3. N.L.A.
40132	DECAL	"Group A", black, std. equipment VK SL Group A. Not to be confused with VK "SS" Group A.
40133	DECAL	"Peter Brock Group A" same application as 40132.
40134	MOULD	LHR roof, black, std. equipment VK "SS" & Group 3.
40135	MOULD	RHR roof, black, VK "SS" & Group 3.
40136	MOULD	LH centre roof, black, VK "SS" & Group 3.
40137	MOULD	RH centre roof, black, VK "SS" & Group 3.
40138	MOULD	LH front roof, black, VK "SS" & Group 3.
40139	MOULD	RH front roof, black, VK "SS" & Group 3.
40140	MOULD	LHR quarter glass belt, black, VK "SS" & Group 3.
40141	MOULD	RHR quarter glass belt, black, VK "SS" & Group 3.
40142	MOULD	LHR door belt, black, VK "SS" & Group 3.
40143	MOULD	RHR door belt, black, VK "SS" & Group 3.
40144	MOULD	LHF door belt, black, VK "SS" & Group 3.
40145	MOULD	RHF door belt, black, VK "SS" & Group 3. PLEASE NOTE: PART NUMBERS 40134 TO 40145 If supply problematic take standard GM unit, mask up rubber area, sandblast bright area, undercoat and paint.
40146	DECAL KIT	Complete, VK "SS" Group A.
40147A	DECAL	Stripe, LHF guard front, VK "SS" Group A.
40147B	DECAL	Stripe, RHF guard front, VK "SS" Group A.
40147C	DECAL	Stripe, LHF guard rear, VK "SS" Group A.
40147D	DECAL	Stripe, RHF guard rear, VK "SS" Group A.
40147E	DECAL	Stripe, LHF door, VK "SS" Group A.
40147F	DECAL	Stripe, RHF door, VK "SS" Group A.
40147G	DECAL	Stripe, LHR door, VK "SS" Group A.
40147H	DECAL	Stripe, RHR door, VK "SS" Group A.
40147I	DECAL	Stripe, LHR quarter panel, VK "SS" Group A.
40147J	DECAL	Stripe, RHR quarter panel, VK "SS" Group A.
40148	DECAL	"SS Group A Peter Brock", VK "SS" Group A.
40149	DECAL	"1st Bathurst", VK "SS" Group A.
40150	DECAL	"SS", silver, VK "SS" Group A.
40151	GRILLE	Front radiator, VK "SS" Group A. Homologated for Group A racing, to Dec. '86.
40152	AIR DAM	Front, VK "SS" Group A. Homologated for Group A racing, to Dec. '86.
40153	SPOILER	Rear deck, VK "SS" Group A. Homologated for Group A racing, to Dec. '86.
40154	STEERING WHEEL	Momo, includes all mounting hardware, i.e. ASM hub, boot, horn button, etc. Std. equipment VK Group A.
40155	STEERING WHEEL	Momo, wheel only, VK Group A.
40156	SPRING ASM	Boot lid support. Asm supports boot lid when open to counteract extra weight of rear spoiler.

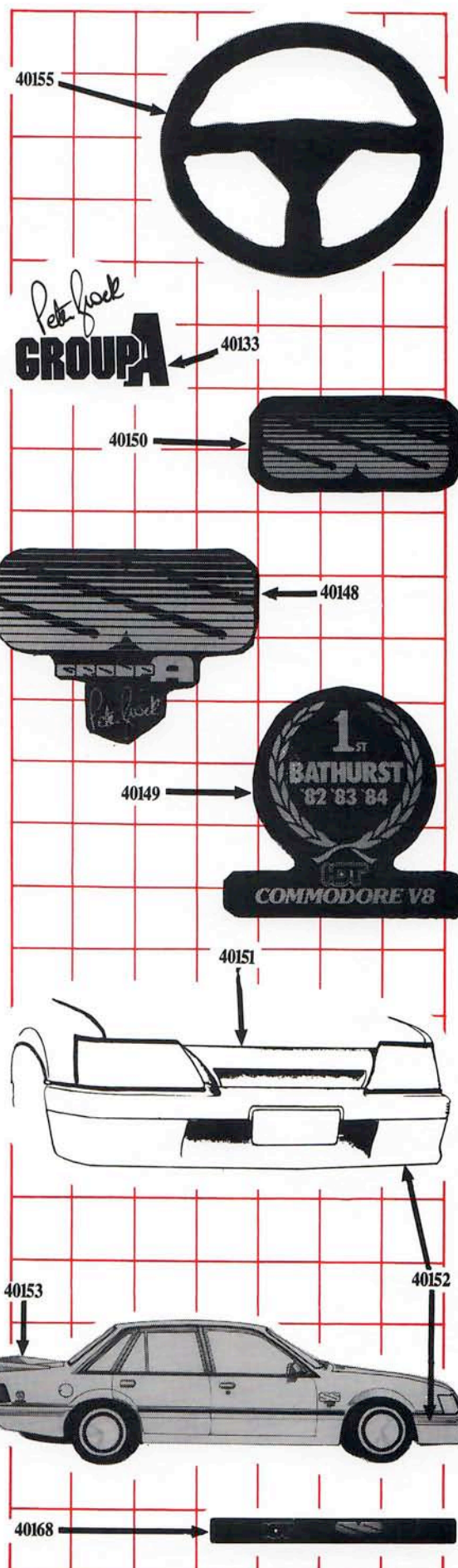

40157	PROTECTORS	"Mobil/HDT" clear plastic head-lamp covers. VH/VK.
40158	NAMEPLATE	"Director", VK HDT Calais.
40159	HARNESS & RELAY	Heavy duty, must be used with 100 & 130 watt head lamp globes, VH/VK.
40160	DECAL	"Group A", silver, VK SL, front guard. Not to be confused with SS Group A.
40161	DECAL	"Peter Brock Group A", silver, VK SL.
40162	DECAL	"Commodore Group A", silver, VK SL boot lid.
40163	DECAL	"Commodore Group A", black, VK SL, boot lid.
40164	BADGE	"Calais" front guard, VK HDT Calais.
40165	BADGE	"HDT" front grille VK.
40166	N.L.A.	
40167	BADGE	"HDT Calais", VK HDT.
40168	BADGE	"HDT SS", dash panel, VK.
40169	AIR DAM	Front, VL HDT LE & Corsa.
40170	GRILLE	Front sports, VL HDT LE.
40171	SKIRT	LH side, VL HDT LE & Corsa. Can be used on earlier models with VL Calais side moulds.
40172	PANEL	LH side rear door, to be used in conjunction with 40171. VL HDT LE & Corsa.
40173	SKIRT	RH side, VL HDT LE & Corsa.
40174	PANEL	RH rear door, use with 40173 VL HDT LE & Corsa.
40175	SPOILER	Rear boot lid, VL HDT LE & Corsa.
40176	BADGE	"LE" boot lid, VL HDT LE.
40177	BADGE	"LE BY HDT", front guard, VL HDT LE.
40178	PLAQUE	Dash panel, VL HDT LE.
40179	SKIRT	Rear underbody, VL HDT LE & Corsa.
40180	GRILLE	Front, VL Group A & Corsa.
40181	DECAL KIT	Full body, VL Corsa Turbo.
40182	DECAL	"Corsa Turbo", VL, LHF bumper. Part of 40181.
40183	DECAL	"Corsa Turbo", VL, RHF bumper. Part of 40181.
40184	DECAL	Stripe, LHF guard. Part of 40181.
40185	DECAL	Stripe, RHF guard. Part of 40181.
40186	DECAL	Stripe, LHF door. Part of 40181.
40187	DECAL	Stripe, RHF door. Part of 40181.
40188	DECAL	Stripe, LHR door. Part of 40181.
40189	DECAL	Stripe, RHR door. Part of 40181.
40190	BADGE	"Corsa Turbo", dash panel, VL.
40191	AIR DAM ASM	Front, VL Group A. Complete with all mounting hardware. Homologated for Group A racing.
40192	AIR DAM	Front, VL Group A, without hardware.
40193	BRACKET	Support (2), part of 40191.
40194	SCREW	Air dam mounting (10), part of 40191.
40195	BONNET SCOOP	VL Group A, homologated for Group A racing.
40196	REAR SPOILER	VL Group A, homologated for Group A racing.
40197	BADGE	"SS", nose panel, VL Group A.
40198	DECAL	"SS Group A" LH front guard, VL Group A.
40199	DECAL	"SS Group A" RH front guard, VL Group A.
40200	DECAL	"SS", bootlid, VL Group A.
40201	PLAQUE	Dash mounted, states build number. VL Group A. Not for general sale.
40202	WHEEL ASM	HDT/Momo steering wheel complete with hub, wheel centre pad, all hardware. VL Group A.
40203	WHEEL & PAD	HDT/Momo steering wheel with pad only, no hardware. VL Group A.
40204	WHEEL ONLY	HDT/Momo bare, VL Group A.
40205	PAD	HDT/Momo steering wheel pad, VL Group A.
40206	DECAL	HDT/Momo steering wheel centre, VL Group A.

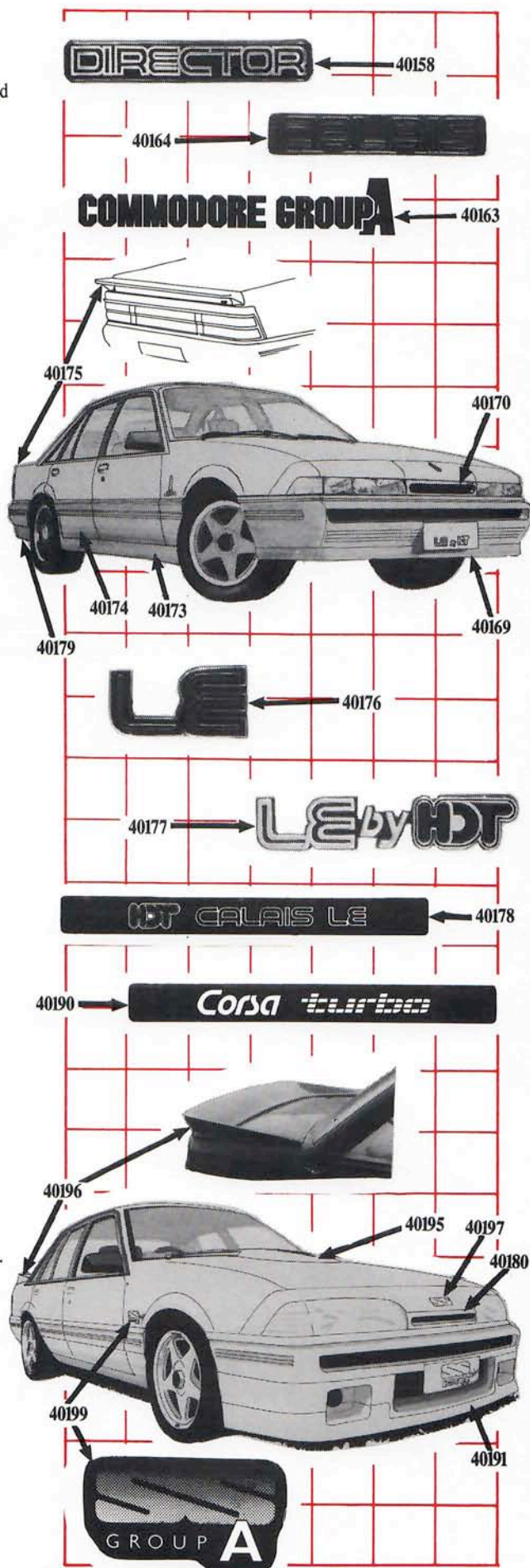



Wheels & Tyres Group

WHEEL & TYRE GROUP

Wheels & Tyres 1

50000	WHEEL	Irmscher 15 x 7 (silver). Standard equipment all VC HDT Commodore; VH "SS" Group 3 and HDT Improved vehicles to August '84.
50001	WHEEL	Irmscher 15 x 7 (black). Standard equipment VK LM5000.
50002	CAP	Irmscher wheel. Suit both silver and black 15 x 7 wheels.
50003	TYRE	Uniroyal Wildcat ER 60H15 (225/60H15). All VC HDT Commodores; VH "SS" Group 3; HDT improved vehicles; LM5000; VK "SS". Not for use Commodore Wagon. N.L.A. from HDT.
50004	TYRE	Pirelli P6 235/60/VR15. Offered as an option on all HDT cars after July '83. Standard equipment Statesman Magnum. Not for use on Commodore Wagon. N.L.A. from HDT.
50005	WHEEL	Momo Polaris 15 x 7 modified by HDT for exclusive use on Statesman Magnum.
50006	NUT	Momo Polaris. When used on Statesman Magnum.
50007	CAP	Momo Polaris. Used on Statesman Magnum.
50008	WHEEL	Centra 16 x 7 modified by HDT for exclusive fitment on HDT model Commodores when offered as an option.
50009	TYRE	Pirelli P7 225/50VR16 when offered as an option on HDT vehicles. Standard equipment VK "SS" Group 3. N.L.A.
50010	VALVE	High performance tyre valve, yellow cap identification. Used all late series VH "SS" Group 3 vehicles on throughout all model range. Not used on Centra 16 x 7 wheels or Momo Polaris 15 x 7.
50011	WHEEL	HDT 15 x 7 left hand complete with sports cap and wheel nuts. Standard equipment VK "SS". Suit all model Commodore. N.L.A. use 50060.
50012	WHEEL	HDT 15 x 7 right hand. Same as 50011. N.L.A. use 50061.
50013	CAP	Used with 15 x 7 & 16 x 7 wheel, Sports type.
50014	SCREW	Stainless steel countersunk. (M6 x 16mm) Secures Sports cap to wheel (HDT 15 x 7 & 16 x 7).
50015	CAPS	Aero type. HDT 15 x 7 & 16 x 7 wheel fitment. Standard equipment VK "SS" Gp3.
50016	SCREW	Stainless steel countersunk. (M6 x 35mm) Secures Aero cap to wheel (HDT 15 x 7 & 16 x 7).
50017	DECAL	"HDT" wheel centre. Standard equipment HDT 15 x 7 & 16 x 7 Sports wheel.
50018	NUT/BLACK	Wheel nut 3/4". Used as standard equipment all HDT alloy wheels when fitted to VK "SS" & Group 3 vehicles.
50019	WHEEL-ASSEMBLY	HDT 15 x 7 left hand complete with Sports & Aero caps & wheel nuts. Suit all model Commodore. N.L.A. use 40062.
50020	WHEEL-ASSEMBLY	HDT 15 x 7 right hand. Same as 50019. N.L.A. use 50063.
50021	WHEEL, BARE	HDT 15 x 7 left hand. N.L.A. use 50058.
50022	WHEEL, BARE	HDT 15 x 7 right hand. N.L.A. use 50059.
50023	WHEEL ASM-SPORTS	HDT 16 x 7 left hand complete with Sports cap & wheel nuts (5). Suit all Commodore sedans.
50024	WHEEL, SPORTS	HDT 16 x 7 right hand complete with Sports cap & wheel nuts (5).
50025	WHEEL, AERO	HDT 16 x 7 left hand complete with Sports & Aero caps & wheel nuts. Standard equipment VK "SS" Group 3.
50026	WHEEL, AERO	HDT 16 x 7 right hand. Same application as 50025.
50027	WHEEL, BARE	HDT 16 x 7 left hand.
50028	WHEEL, BARE	HDT 16 x 7 right hand.
50029	WHEEL, AERO	HDT 15 x 7 left hand complete with Sports & Aero caps & wheel nuts, HQ bolt pattern and offset. Suit WB Statesman & earlier models. Silver painted. N.L.A.
50030	WHEEL, AERO	HDT 15 x 7 right hand. Same application as 50029. N.L.A.

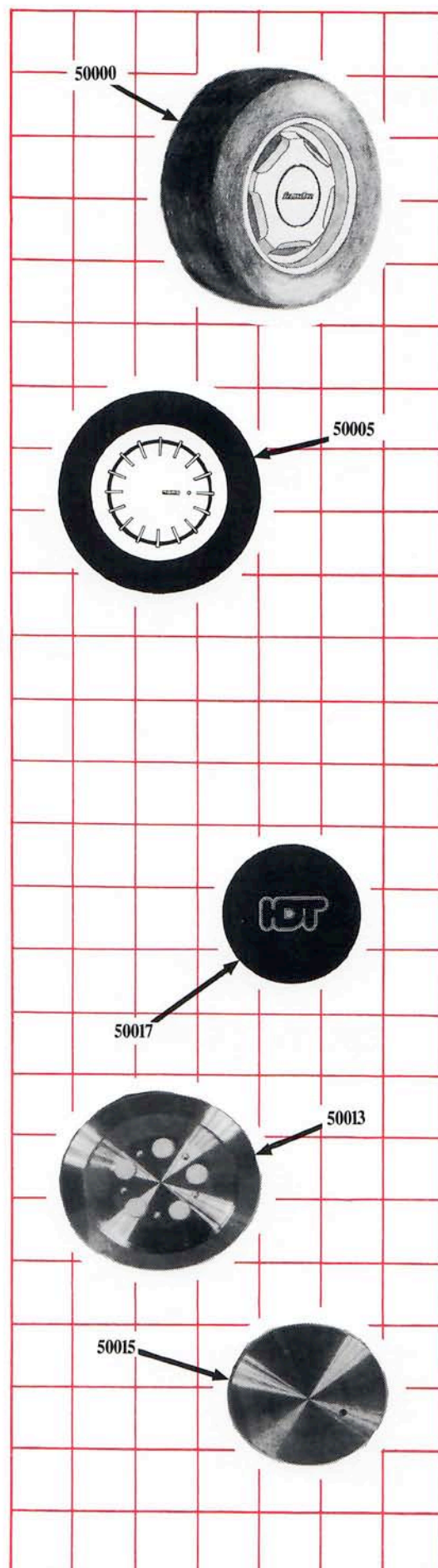

50031	CAP	HDT sports type. Painted silver for use with all silver painted 15 x 7 & 16 x 7 wheels as fitted to Commodore & Statesman.
50032	CAP	HDT Aero. Painted silver. Same application as 50031.
50033	WHEEL, BARE	HDT 15 x 7 silver left hand. WB Statesman.
50034	WHEEL, BARE	HDT 15 x 7 silver right hand. WB Statesman.
50035	WHEEL ASSEMBLY	HDT 15 x 7 silver painted left hand complete with Sports cap & nuts. Suit all model Commodore. N.L.A. use 50060.
50036	WHEEL ASSEMBLY	HDT 15 x 7 silver painted right hand complete. Same application as 50035. N.L.A. use 50061.
50037	WHEEL, BARE	HDT 15 x 7 silver left hand. Commodore. N.L.A. use 50058.
50038	WHEEL, BARE	HDT 15 x 7 silver right hand. Commodore. N.L.A. use 50059.
50039	TOOL	HDT hub cap. For use with Irmischer 15 x 7 wheel.
50040	TYRE	Yokohama A008 225/50VR16 when offered as an option on HDT vehicles.
50041	TYRE	Bridgestone Potenza 225/50VR16 when offered as an option on HDT vehicles. Standard equipment - VK Group A.
50042	WHEEL, BARE	HDT 16 x 7 LH, white.
50043	WHEEL, BARE	HDT 16 x 7 RH, white.
50044	WHEEL, SPORTS	HDT 16 x 7 LH, white.
50045	WHEEL, SPORTS	HDT 16 x 7 RH, white.
50046	WHEEL, AERO	HDT 16 x 7 LH, white.
50047	WHEEL, AERO	HDT 16 x 7 RH, white.
50048	CAPS, SPORTS	HDT 16 x 7, white.
50049	CAP, AERO	HDT 16 x 7, white.
50050	KEY	Allen, for HDT aero cap removal.
50051	TYRE	Yokohama, 215/60VR15 A008, N.L.A. from HDT.
50052	TYRE	Avon, 215/60VR15, N.L.A. from HDT.
50053	WHEEL ASM	HDT/Momo 16 x 7 Star.
50054	WHEEL ASM	HDT/Momo 16 x 8 Star.
50055	TOOL	HDT/Momo Star Wheel centre nut, removal.
50056	PLATE	HDT/Momo Star Wheel centre cover.
50057	NUT	HDT/Momo Star Wheel centre.
50058	EMBLEM	HDT/Momo Star wheel, "HDT" centre nut.
50059	WHEEL, BARE	HDT 15 x 7 LH.
50060	WHEEL, BARE	HDT 15 x 7 RH.
50061	WHEEL, SPORTS	HDT 15 x 7 LH.
50062	WHEEL, SPORTS	HDT 15 x 7 RH.
50063	WHEEL, AERO	HDT 15 x 7 LH.
50064	WHEEL, AERO	HDT 15 x 7 RH.

